

SERVO-DRIVE for drawers



SERVO-DRIVE for drawers

Opening feature for TANDEM and TANDEMBOX

More comfort for your customers



Easy opening silent and effortless closing

SERVO-DRIVE is a low voltage electronic opening feature for TANDEM and TANDEMBOX drawers. By combining this feature with the silent and effortless closing action of BLUMOTION, we have taken perfecting motion to a new level. Customers will be amazed by the quality and ease of use.



Contents

4	Using the SERVO-DRIVE catalog
6	SERVO-DRIVE program overview
8	TANDEM plus BLUMOTION
40	TANDEMBOX
56	Waste/recycle set
57	Power supply set
58	Electrical components
60	Distance bumpers
61	Wiring options
62	Assembly/removal
66	Assembly aids
68	Accessories
69	Part number index

Using the SERVO-DRIVE catalog

Step 1

Determine application

Based on either TANDEM or TANDEMBOX, choose the application that best fits your design. Then proceed to the corresponding catalog page for specific information.

TANDEM plus BLUMOTION



TANDEMBOX



Step 2

Select parts

Choose the parts needed from the first two pages of each application



Step 3

Prepare cabinet

Refer to the boring location requirements chart to obtain the minimum inside cabinet depth and boring locations.

Using the location from the chart, pre-bore holes and install adapters or bracket.

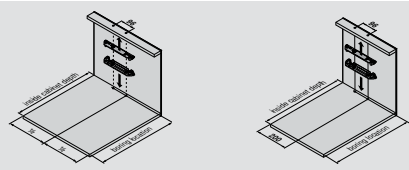

	boring location requirements							
profile length	229 (9")	305 (12")	381 (15")	457 (18")	533 (21")	610 (24")	686 (27")	762 (30")
boring location	253 (9-15/16")	329 (12-15/16")	405 (15-15/16")	481 (18-15/16")	557 (21-15/16")	634 (24-15/16")	710 (27-15/16")	786 (30-15/16")
minimum inside cabinet depth	270 (10-5/8")	346 (13-5/8")	422 (16-5/8")	498 (19-5/8")	574 (22-5/8")	651 (25-5/8")	727 (28-5/8")	803 (31-5/8")

Step 4

Install profile

Install profile into adapters or bracket

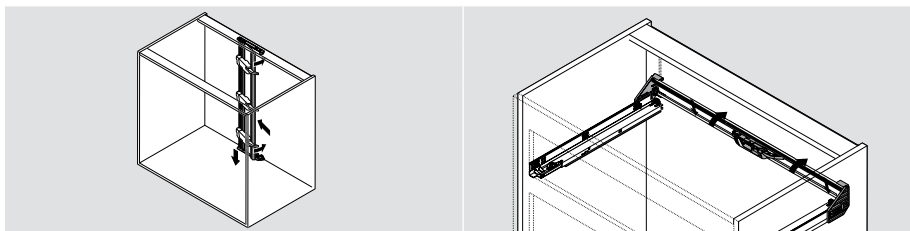

Step 5

Attach drive units

Attach the necessary number of drive units to the profile or bracket and ensure the arm contacts the center of the drawer back

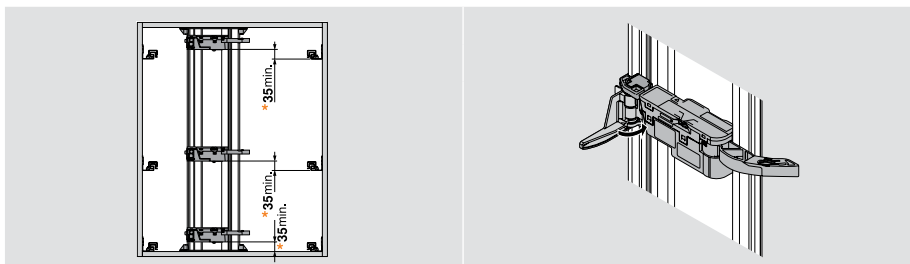

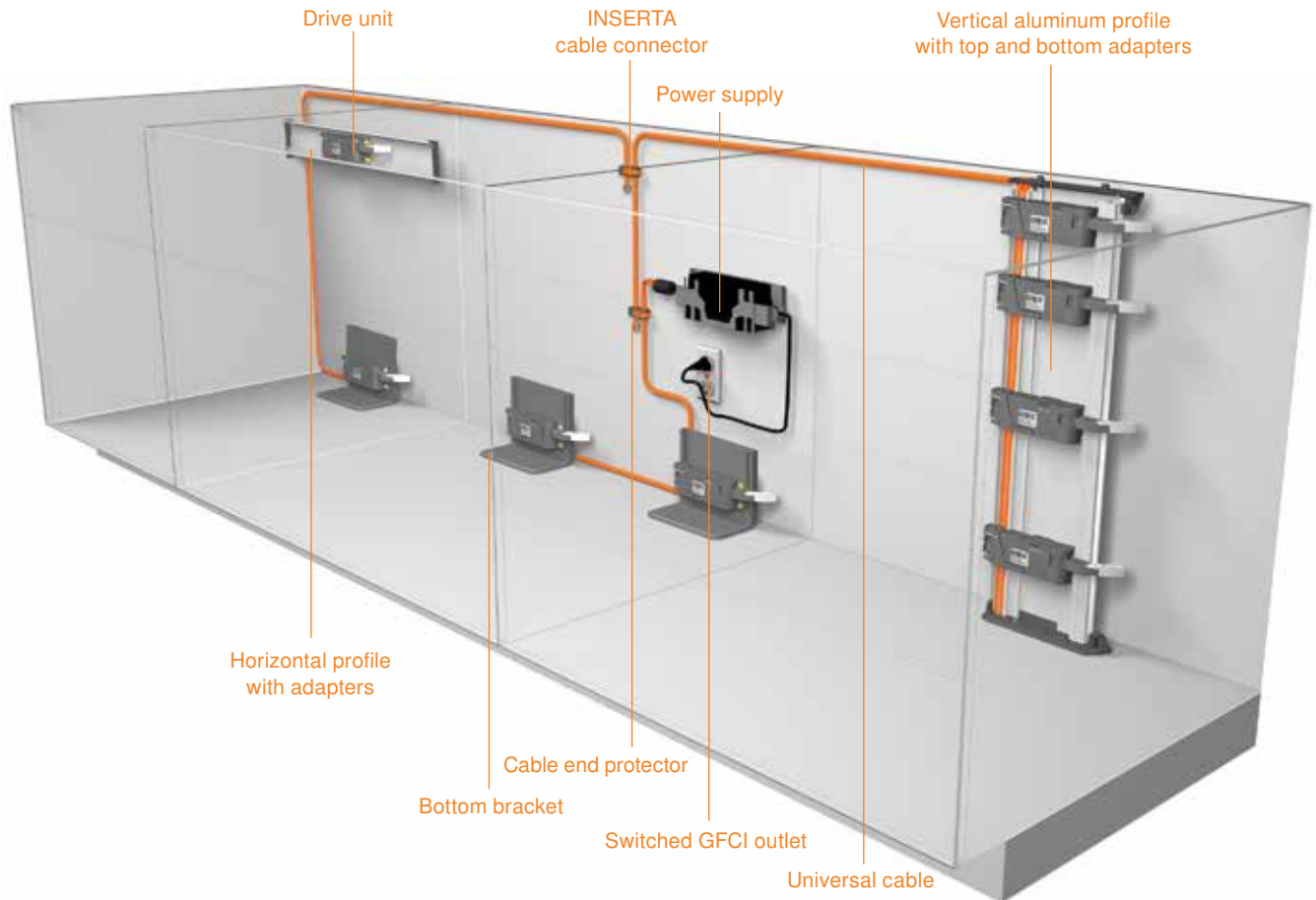

Step 6

Wire the cabinet

Connect necessary cable with INSERTA cable connectors and cap off with cable end protectors

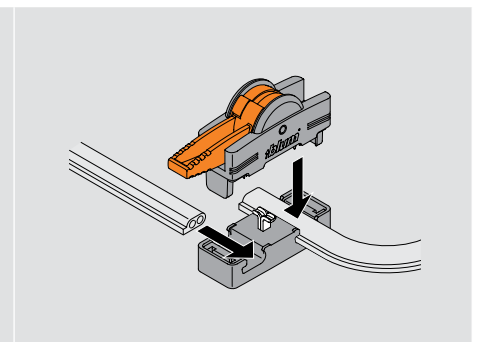
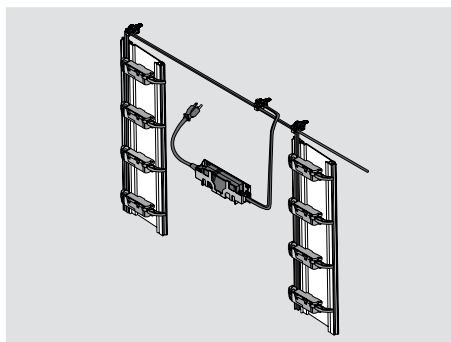

Step 7

Connect power supply

Attach wall mount bracket and insert power supply. Plug three-prong power cord into switched GFCI outlet.

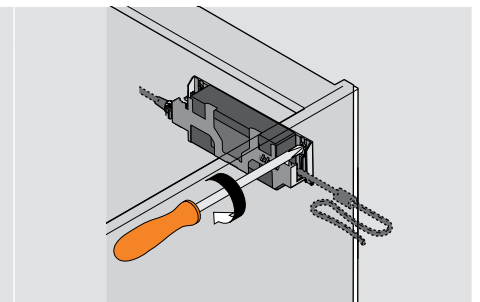
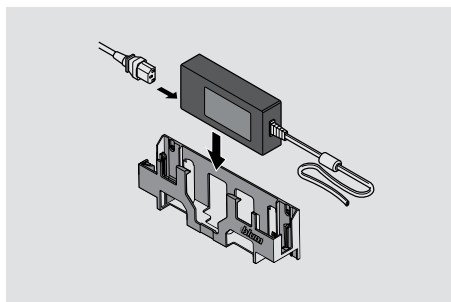

SERVO-DRIVE program overview

Vertical aluminum profile



TANDEM
TANDEM inset

page	8
page	12



TANDEMBOX

page	40
------	----

Horizontal aluminum profile



TANDEM
TANDEM inset

page	16
page	20



TANDEMBOX

page	44
------	----

Top bracket



TANDEM
TANDEM inset

page	24
page	28



TANDEMBOX

page	48
------	----

Bottom bracket



TANDEM

page 32

TANDEM inset

page 36



TANDEMBOX

page 52

Waste/recycle set



TANDEM Waste/recycle set

page 56



TANDEMBOX Waste/recycle set

page 56

Power supply set



Power supply set

page 57

TANDEM plus BLUMOTION – Vertical aluminum profile

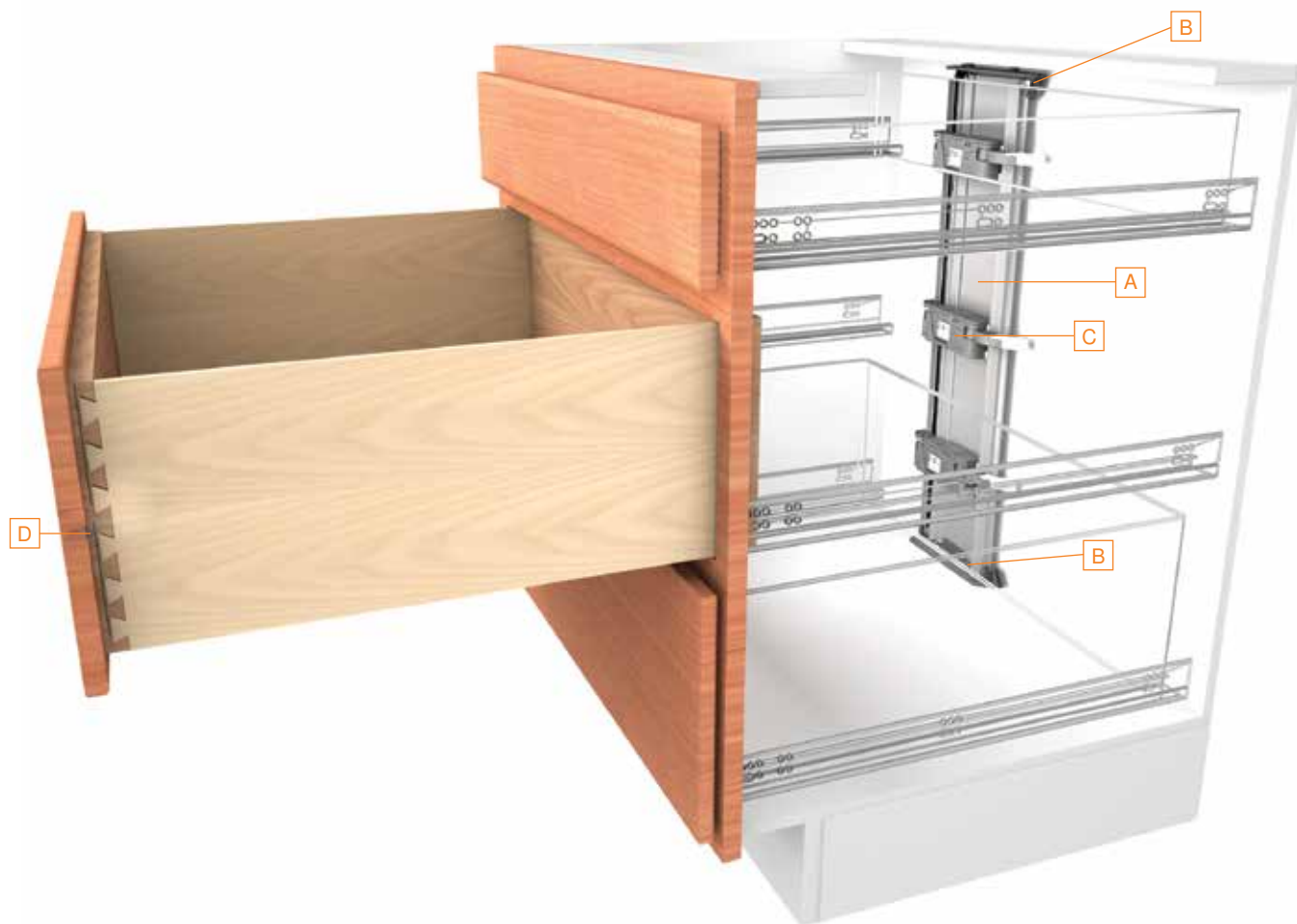

Vertical aluminum profile

A Profile can be cut to size

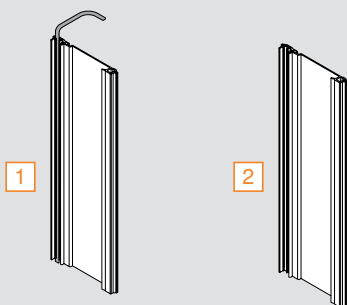

*cable length 800 (31-1/2")

Part no.

1 Profile with cable, length 720 (28-3/8")*

Z10T720AB

2 Profile without cable, length 1170 (46")

Z10T1170A

Top and bottom adapter set

B For use with horizontal stretcher rail

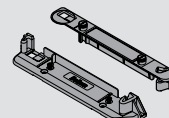

Part no.

Top and bottom adapter set

Z10D01E0.01

Back and bottom adapter set

B For use with back stretcher rail

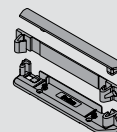

Part no.

Back and bottom adapter set with cover cap

Z10D01EA.01



Drive unit

C

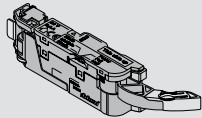

Part no.

Installation

pg 63

Drive unit

Z10A3000.02

Blum distance bumper

D

Provides 3 (1/8") gap



Part no.

1 Ø5 mm bumper

993.0531

2 Screw-on bumper

993.1220

Specifications

pg 60

Power supply set

Set includes:

- 19 ft universal cable
- 72 watt power supply
- Wall mount bracket
- Three-prong power cord
- Cable end protector (qty 3)
- INSERTA cable connector
- Cable clips (qty 10)
- Technical information

Part no.

Details

pg 57

Power supply set

Z10NE02UG10

Vertical aluminum profile top and bottom adapter

Specifications

Space requirements

For opening widths **340** (13-3/8") and wider

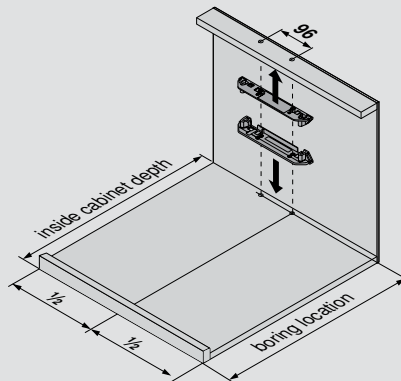

For opening widths **275 to 339** (10-13/16" – 13-3/8")

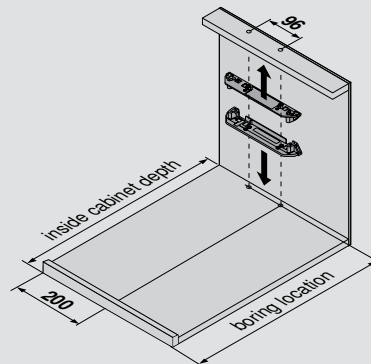

boring location requirements

drawer length	229 (9")	305 (12")	381 (15")	457 (18")	533 (21")	610 (24")	686 (27")	762 (30")
boring location	253 (9-15/16")	329 (12-15/16")	405 (15-15/16")	481 (18-15/16")	557 (21-15/16")	634 (24-15/16")	710 (27-15/16")	786 (30-15/16")
min. inside cabinet depth	270 (10-5/8")	346 (13-5/8")	422 (16-5/8")	498 (19-5/8")	574 (22-5/8")	651 (25-5/8")	727 (28-5/8")	803 (31-5/8")

NOTE: 41 (1-5/8") is required between drawer back and back panel

Boring specifications

Top and bottom boring pattern

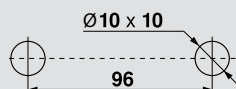

Calculating vertical profile length

Profile length = inside cabinet height minus **19** (3/4")

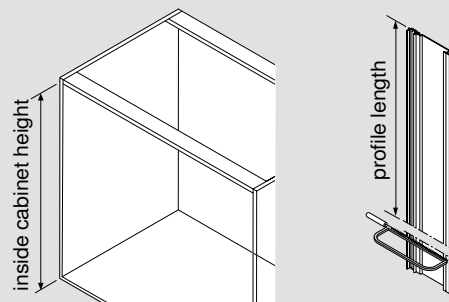

Installing vertical aluminum profile

- 1 Set profile onto bottom adapter
- 2 Push profile toward left side while engaging top
- 3 Push back on right side and snap into place

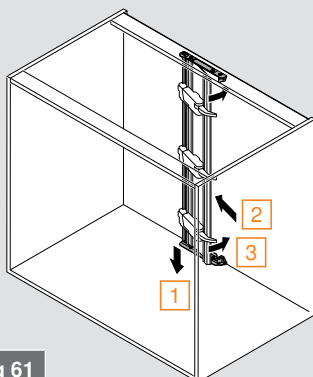

Wiring options **pg 61**

Positioning the drive unit

Lever arm should contact center of drawer back

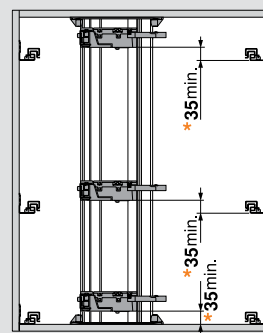

* If opening width is less than **420** (16-9/16"), drive unit should be mounted **50** (1-15/16") minimum from bottom of runner

Vertical aluminum profile back and bottom adapter

Specifications

Space requirements

For opening widths **340** (13-3/8") and wider

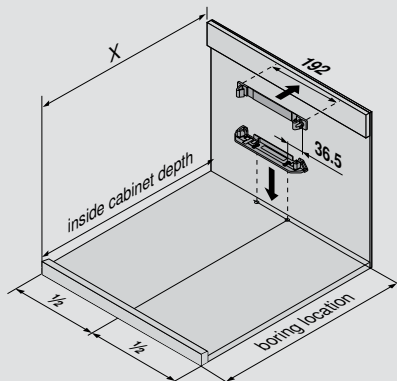

For opening widths **275 to 339** (10-13/16" – 13-3/8")

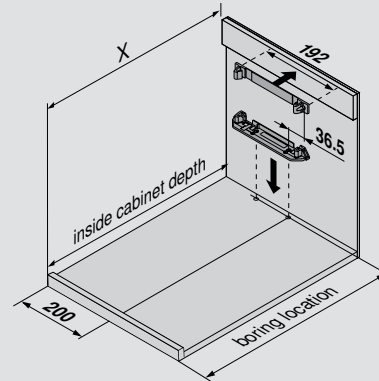

X is same as boring location

boring location requirements

drawer length	229 (9")	305 (12")	381 (15")	457 (18")	533 (21")	610 (24")	686 (27")	762 (30")
X and boring location	253 (9-15/16")	329 (12-15/16")	405 (15-15/16")	481 (18-15/16")	557 (21-15/16")	634 (24-15/16")	710 (27-15/16")	786 (30-15/16")
min. inside cabinet depth	270 (10-5/8")	346 (13-5/8")	422 (16-5/8")	498 (19-5/8")	574 (22-5/8")	651 (25-5/8")	727 (28-5/8")	803 (31-5/8")

NOTE: 41 (1-5/8") is required between drawer back and back panel

Boring specifications

Back screw positioning

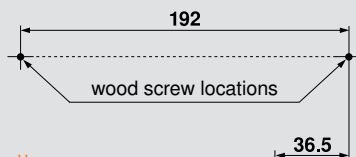

Bottom boring pattern

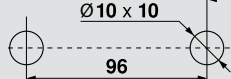

Determining vertical profile length

Profile length is dependent upon back adapter location.

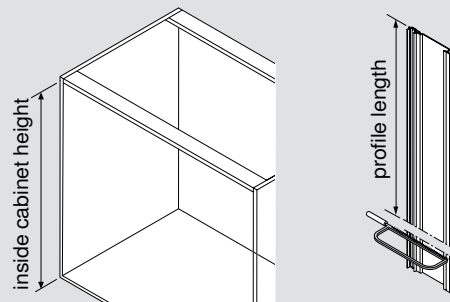

Installing vertical aluminum profile

- 1 Set profile onto bottom adapter
- 2 Push profile toward back while engaging adapter
- 3 Snap cover cap onto top of profile

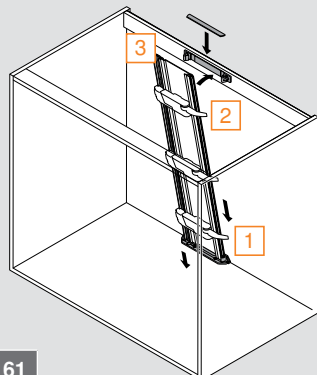

Wiring options pg 61

Positioning the drive unit

Lever arm should contact center of drawer back

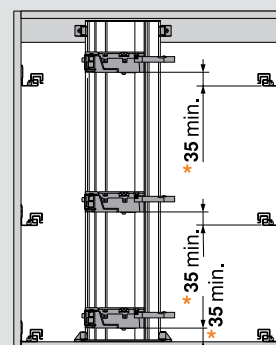

* If opening width is less than **420** (16-9/16"), drive unit should be mounted **50** (1-15/16") minimum from bottom of runner

TANDEM plus BLUMOTION

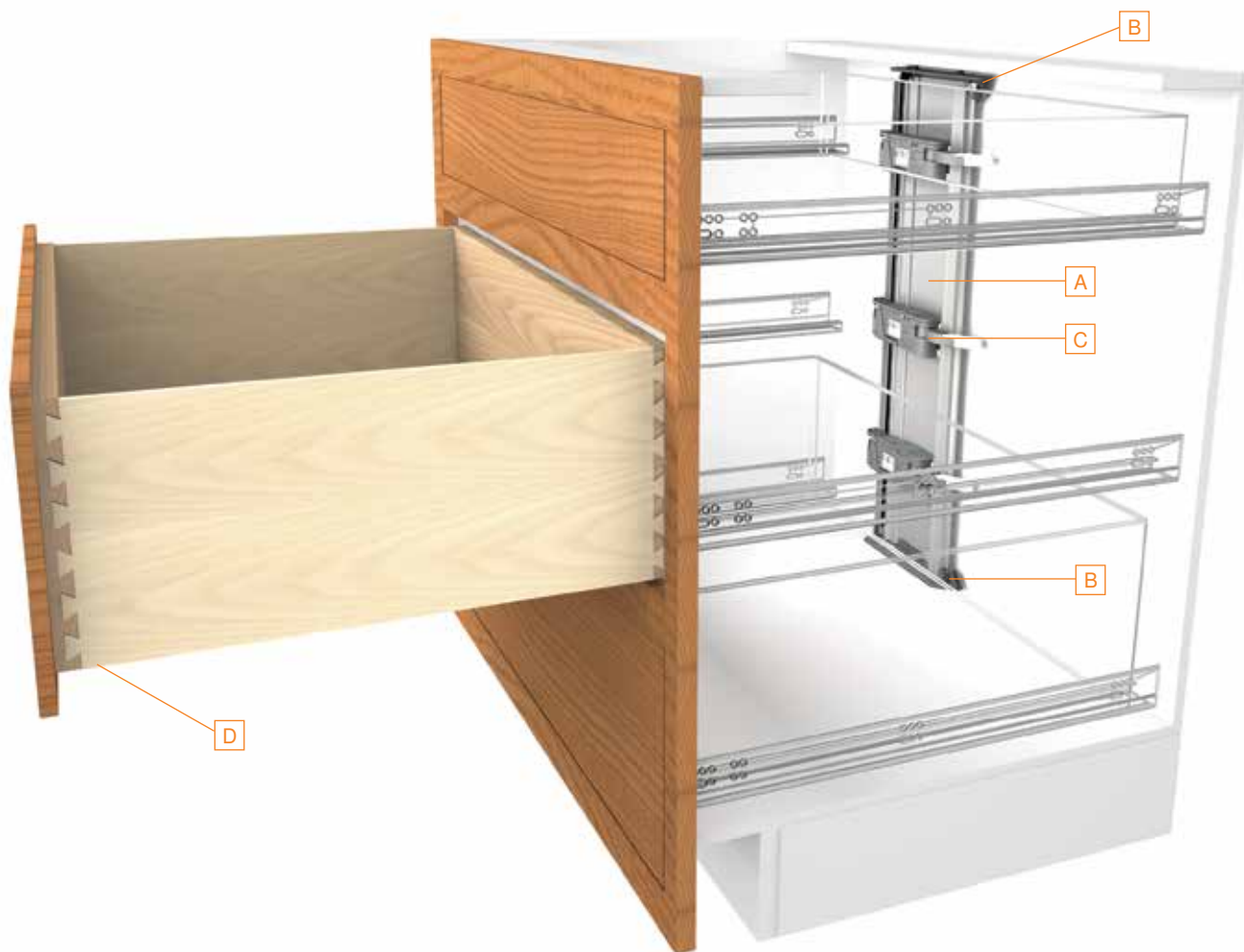

Vertical aluminum profile

A Profile can be cut to size

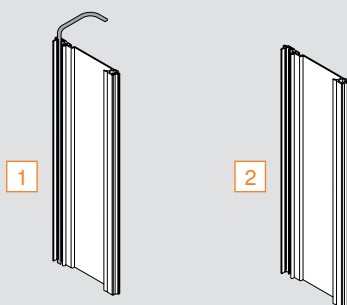

*cable length **800** (31-1/2")

Part no.

1 Profile with cable, length **720** (28-3/8")*

Z10T720AB

2 Profile without cable, length **1170** (46")

Z10T1170A

Top and bottom adapter set

B For use with horizontal stretcher rail

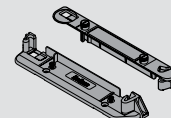

Part no.

Top and bottom adapter set

Z10D01E0.01

Drive unit

C

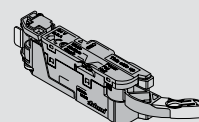

Part no.

Installation

pg 63

Drive unit

Z10A3000.02

Inset vertical aluminum profile



SERVO-DRIVE locking device with integrated bumper

D Provides 3 (1/8") gap

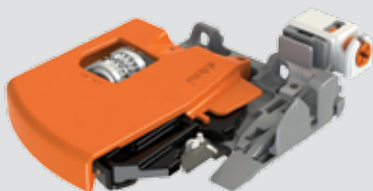

Part no.

SERVO-DRIVE locking device, left

T51.1901.PS L

SERVO-DRIVE locking device, right

T51.1901.PS R

Power supply set

Set includes:

- 19 ft universal cable
- 72 watt power supply
- Wall mount bracket
- Three-prong power cord
- Cable end protector (qty 3)
- INSERTA cable connector
- Cable clips (qty 10)
- Technical information

Part no.

Details

pg 57

Power supply set

Z10NE02UG10

TANDEM plus BLUMOTION

Specifications

Space requirements

For opening widths **340** (13-3/8") and wider

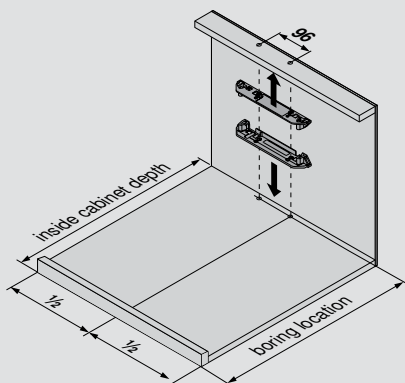

For opening widths **275 to 339** (10-13/16" – 13-3/8")

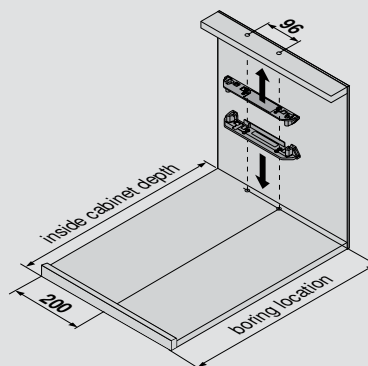

Boring specifications

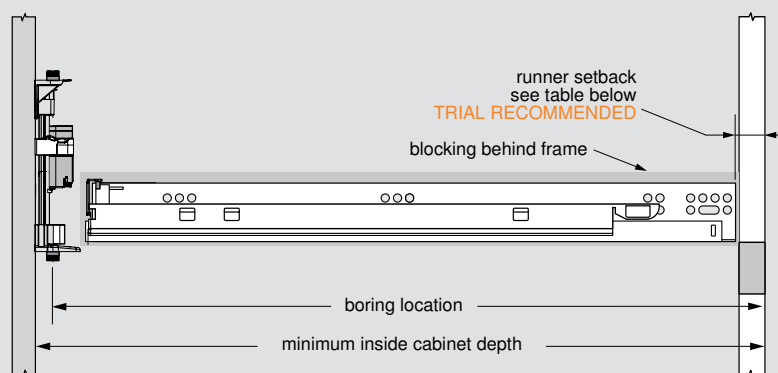

boring location requirements

boring location = drawer length + **21** (13/16") + runner setback

minimum inside cabinet depth = drawer length + **38** (1-1/2") + runner setback

Mounting the TANDEM runner for inset application

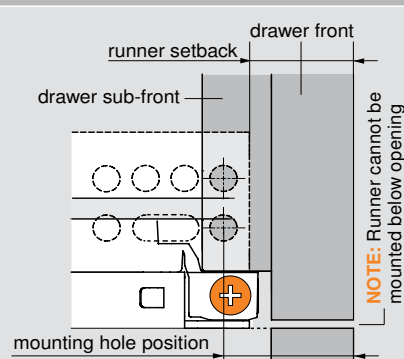

563/569 H/.		runner setback			563/569 F/A		runner setback		
sub-front thickness	13 (1/2")	20 (25/32")	23 (29/32")	26 (1-1/32")	sub-front thickness	13 (1/2")	17 (21/32")	20 (25/32")	23 (29/32")
	16 (5/8")	23 (29/32")	26 (1-1/32")	29 (1-5/32")		16 (5/8")	20 (25/32")	23 (29/32")	26 (1-1/32")
	19 (3/4")	26 (1-1/32")	29 (1-5/32")	32 (1-1/4")		19 (3/4")	23 (29/32")	26 (1-1/32")	29 (1-5/32")
		drawer front thickness					drawer front thickness		
		16 (5/8")	19 (3/4")	22 (7/8")			16 (5/8")	19 (3/4")	22 (7/8")

- Setbacks in this table recess the face of the drawer front inside of the cabinet **1** (1/32")
- The depth adjustment can then be used to move the drawer front out to its desired position, **2.5** (3/32") out adjustment only

calculating runner setback

563/569 H/. (sub-front thickness + drawer front thickness minus **9** (11/32") = runner setback)

563/569 F/A (sub-front thickness + drawer front thickness minus **12** (15/32") = runner setback)

NOTE: For mounting hole position, add **7** (9/32") to runner setback

Inset vertical aluminum profile

Boring specifications

Top and bottom boring pattern

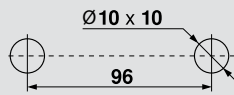

Calculating vertical profile length

Profile length = inside cabinet height minus 19 (3/4")

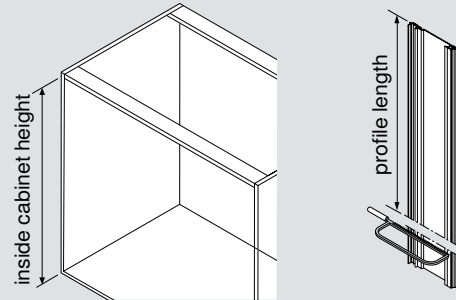

Installing vertical aluminum profile

- 1 Set profile onto bottom adapter
- 2 Push profile toward left side while engaging top
- 3 Push back on right side and snap into place

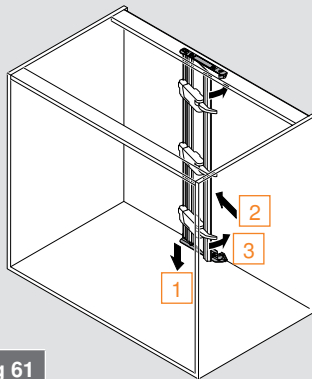

Wiring options pg 61

Positioning the drive unit

Lever arm should contact center of drawer back

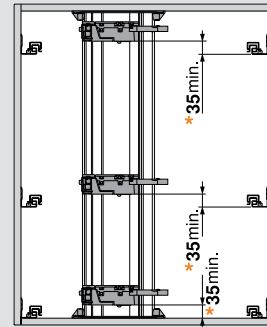

* If opening width is less than 420 (16-9/16"), drive unit should be mounted 50 (1-15/16") minimum from bottom of runner

SERVO-DRIVE locking device with integrated bumper

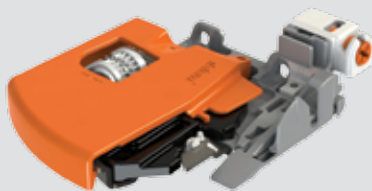

- Captive right device and self-aligning left device
- Self-adjusting drawer length tolerance
- Minimum inside drawer width 170 (6-11/16")
- Height adjustment +3 (1/8")
- Side adjustment ±1.5 (1/16")
- Depth adjustment +2.5 (3/32"), preset at 0
- Minimum sub-front thickness 13 (1/2")
- Designed for 13 (1/2") drawer bottom recess
- Integrated 3 (1/8") distance bumper for inset or overlay SERVO-DRIVE applications

Installation pg 64

TANDEM plus BLUMOTION



NOTE: For face frame application with rear attachment

Horizontal aluminum profile

A

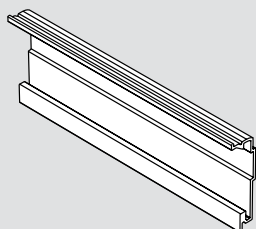

Part no.

Profile length **1143** (45"), cut to size

Z10T1143B

Adapter set for horizontal profile, face frame

Set includes:

- TANDEM adapters (left and right)
- Profile adapter
- Installation screws 661.1150.HG (qty 4)
- Installation instructions

B

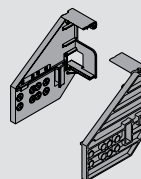

C

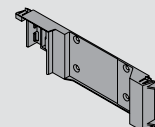

Part no.

Adapter set for horizontal profile, face frame

Z10D5800.US

Horizontal aluminum profile



Drive unit

D

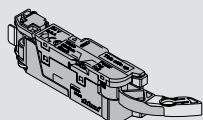

Part no.

Installation

pg 63

Drive unit

Z10A3000.02

Blum distance bumper

E Provides 3 (1/8") gap

1



2



Part no.

1 Ø5 mm bumper

993.0531

2 Screw-on bumper

993.1220

Specifications

pg 60

Power supply set

Set includes:

- 19 ft universal cable
- 72 watt power supply
- Wall mount bracket
- Three-prong power cord
- Cable end protector (qty 3)
- INSERTA cable connector
- Cable clips (qty 10)
- Technical information

Part no.

Details

pg 57

Power supply set

Z10NE02UG10

TANDEM plus BLUMOTION

Specifications

Space requirements

Works with most TANDEM 563 lengths. Minimum opening width is **305 (12")**

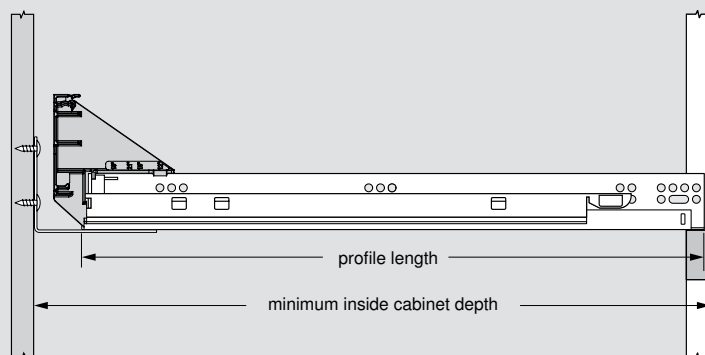

cabinet depth requirements

drawer length	305 (12")	381 (15")	457 (18")	533 (21")	
minimum inside cabinet depth	346 (13-5/8")	422 (16-5/8")	498 (19-5/8")	574 (22-5/8")	

NOTE: 41 (1-5/8") is required between drawer back and back panel

Mounting of adapters

1 Slide the adapters firmly onto each runner

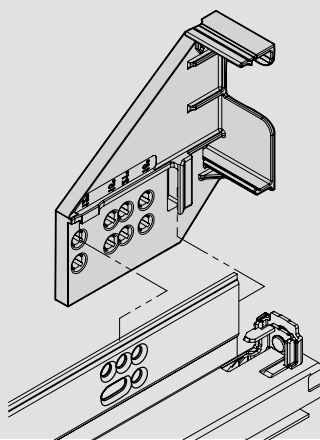

2 Attach with system screws (661.1150.HG)

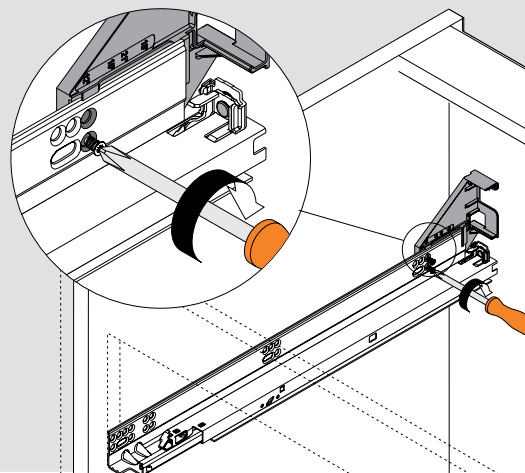

Calculating horizontal profile size

Profile length = interior cabinet opening width minus **19 (3/4")**

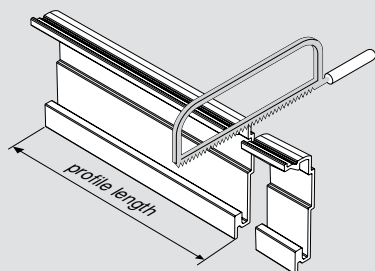

Horizontal aluminum profile

Installing profile adapter onto horizontal profile

- 1 Place bottom of profile adapter into the bottom slot of profile

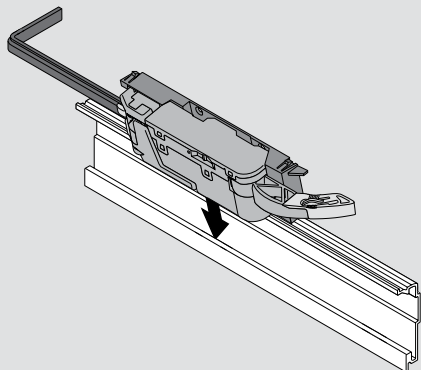

- 2 Push top of profile adapter toward the back of the profile and snap into place

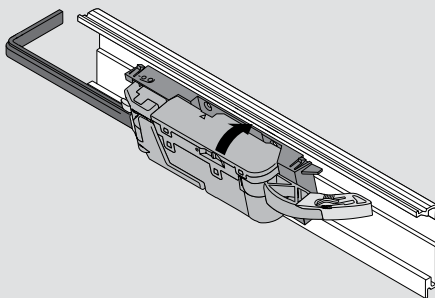

- 3 Align cable along bottom slot of profile

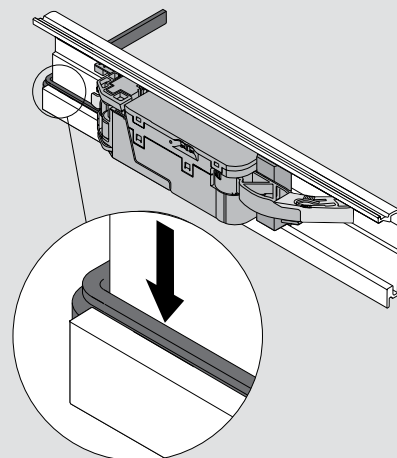

Installing horizontal profile into adapters

- 1 Slide cable through the notch in the adapter
- 2 Push horizontal profile toward bottom
- 3 Push top of profile to snap into place

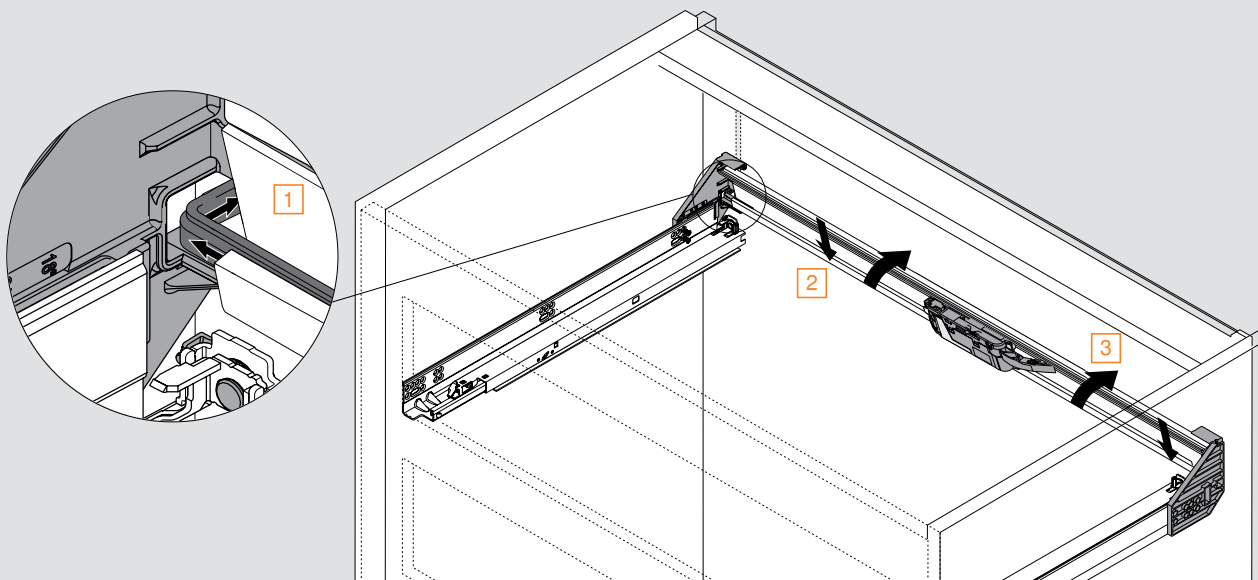

TANDEM plus BLUMOTION

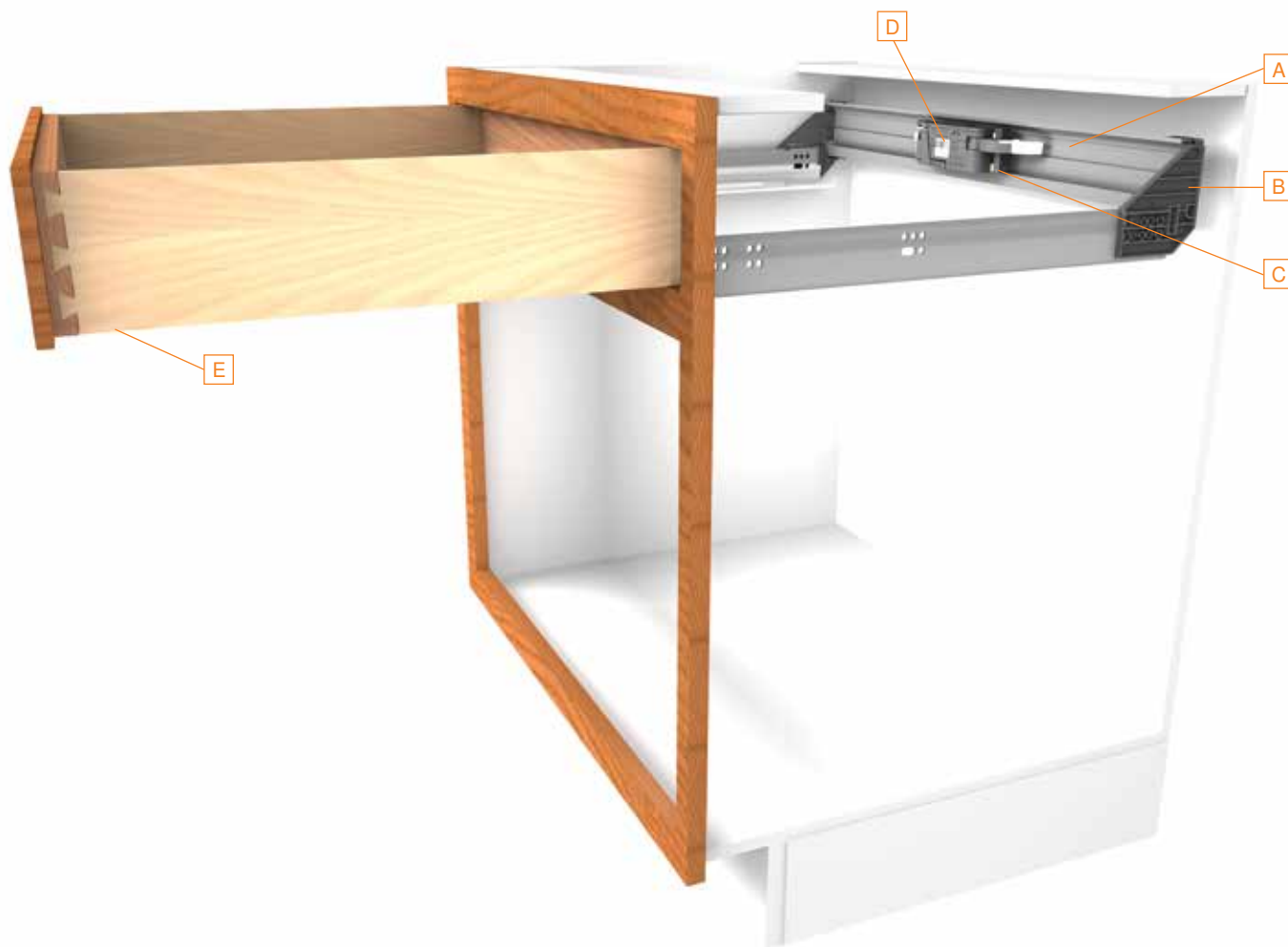

NOTE: For face frame application with rear attachment

Horizontal aluminum profile

A

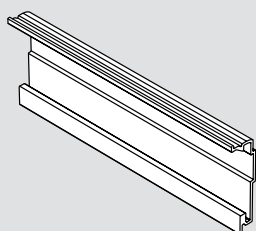

Part no.

Profile length **1143** (45"), cut to size

Z10T1143B

Adapter set for horizontal profile, face frame

Set includes:

- TANDEM adapters (left and right)
- Profile adapter
- Installation screws 661.1150.HG (qty 4)
- Installation instructions

B

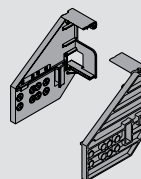

C

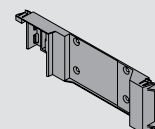

Part no.

Adapter set for horizontal profile, face frame

Z10D5800.US

Inset horizontal aluminum profile



Drive unit

D

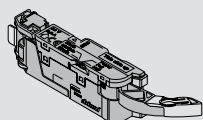

Part no.

Installation

pg 63

Drive unit

Z10A3000.02

SERVO-DRIVE locking device with integrated bumper

E

Provides 3 (1/8") gap



Part no.

SERVO-DRIVE locking device, left

T51.1901.PS L

SERVO-DRIVE locking device, right

T51.1901.PS R

Power supply set

Set includes:

- 19 ft universal cable
- 72 watt power supply
- Wall mount bracket
- Three-prong power cord
- Cable end protector (qty 3)
- INSERTA cable connector
- Cable clips (qty 10)
- Technical information

Part no.

Details

pg 57

Power supply set

Z10NE02UG10

TANDEM plus BLUMOTION

Specifications

Space requirements

Works with most TANDEM 563 lengths. Minimum opening width is **305 (12")**.

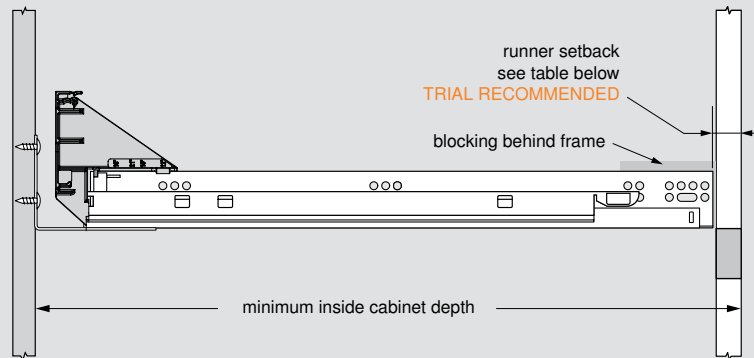

cabinet depth requirements

minimum inside cabinet depth = drawer length + **38 (1-1/2")** + runner setback

Mounting the TANDEM runner for inset application

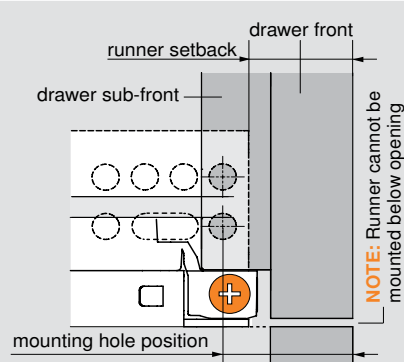

563/569 H/L		runner setback				563/569 F/A		runner setback			
sub-front thickness	13 (1/2")	20 (25/32")	23 (29/32")	26 (1-1/32")		sub-front thickness	13 (1/2")	17 (21/32")	20 (25/32")	23 (29/32")	26 (1-1/32")
	16 (5/8")	23 (29/32")	26 (1-1/32")	29 (1-5/32")			16 (5/8")	20 (25/32")	23 (29/32")	26 (1-1/32")	29 (1-5/32")
	19 (3/4")	26 (1-1/32")	29 (1-5/32")	32 (1-1/4")			19 (3/4")	23 (29/32")	26 (1-1/32")	29 (1-5/32")	32 (1-1/4")
		16 (5/8")	19 (3/4")	22 (7/8")				16 (5/8")	19 (3/4")	22 (7/8")	
drawer front thickness						drawer front thickness					

- Setbacks in this table recess the face of the drawer front inside of the cabinet **1 (1/32")**
- The depth adjustment can then be used to move the drawer front out to its desired position, **2.5 (3/32")** out adjustment only

calculating runner setback

563/569 H/L (sub-front thickness + drawer front thickness minus **9 (11/32")**) = runner setback

563/569 F/A (sub-front thickness + drawer front thickness minus **12 (15/32")**) = runner setback

NOTE: For mounting hole position, add **7 (9/32")** to runner setback

SERVO-DRIVE locking device with integrated bumper



- Captive right device and self-aligning left device
- Self-adjusting drawer length tolerance
- Minimum inside drawer width **170 (6-11/16")**
- Height adjustment **+3 (1/8")**
- Side adjustment **±1.5 (1/16")**
- Depth adjustment **+2.5 (3/32")**, preset at **0**
- Minimum sub-front thickness **13 (1/2")**
- Designed for **13 (1/2")** drawer bottom recess
- Integrated **3 (1/8")** distance bumper for inset or overlay SERVO-DRIVE applications

Installation **pg 64**

Calculating horizontal profile size

Profile length = interior cabinet opening width minus **19 (3/4")**

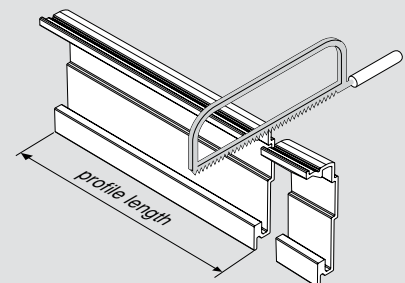

Inset horizontal aluminum profile

Mounting adapters

- 1 Slide the adapters firmly onto each runner

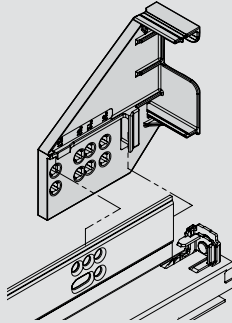

- 2 Attach with system screws (661.1150.HG)

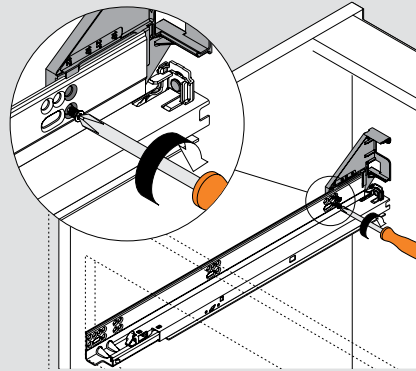

Installing profile adapter onto horizontal profile

- 1 Place bottom of profile adapter into the bottom slot of profile

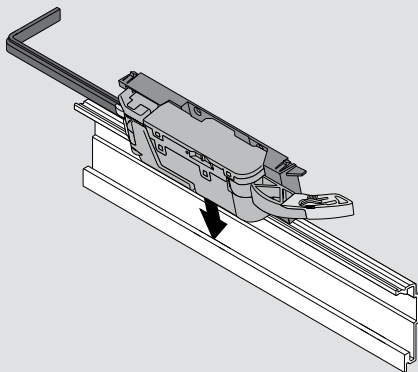

- 2 Push top of profile adapter toward the back of the profile and snap into place

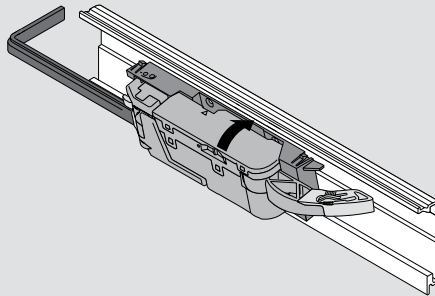

- 3 Align cable along bottom slot of profile

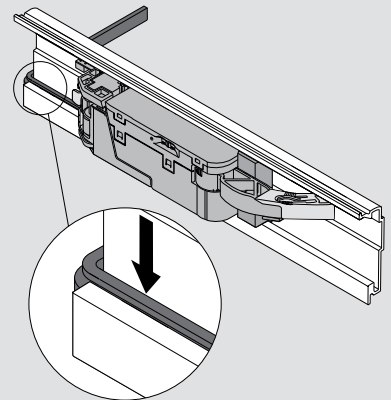

Installing horizontal profile into adapters

- 1 Slide cable through the notch in the adapter
- 2 Push horizontal profile toward bottom
- 3 Push top of profile to snap into place

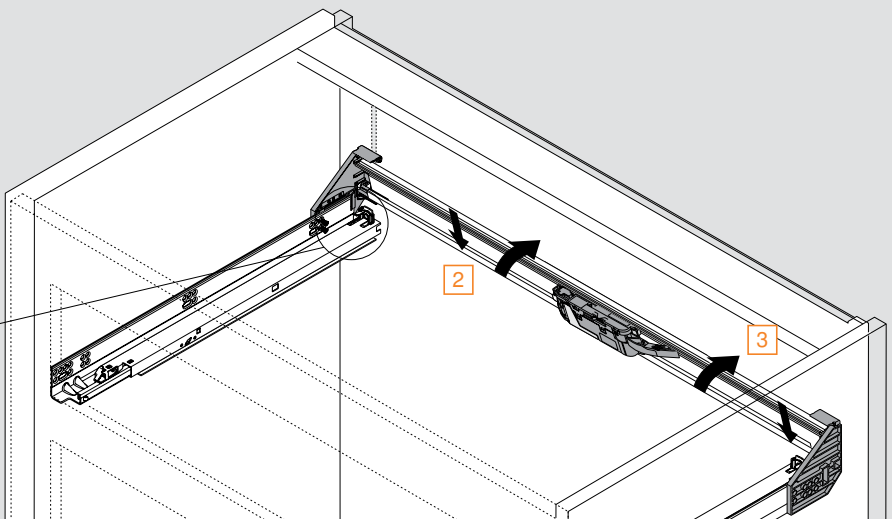
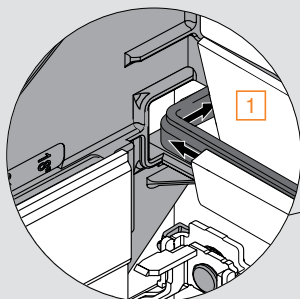

Wiring options pg 61

TANDEM plus BLUMOTION



Top bracket with adapter

A

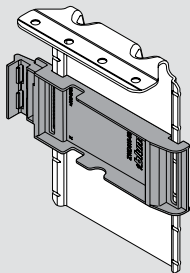

Part no.

Top bracket with adapter	Z10D6252
Installation screw	661.1300.HG

Drive unit

B

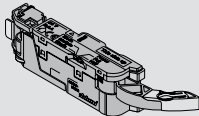

Part no.

Installation	pg 63	Drive unit	Z10A3000.02
--------------	-------	------------	-------------

Blum distance bumper

C Provides 3 (1/8") gap



Part no.

		1 Ø5 mm bumper	993.0531
Specifications	pg 60	2 Screw-on bumper	993.1220

Top bracket



Power supply set

Set includes:

- 19 ft universal cable
- 72 watt power supply
- Wall mount bracket
- Three-prong power cord
- Cable end protector (qty 3)
- INSERTA cable connector
- Cable clips (qty 10)
- Technical information

Part no.

Details

pg 57

Power supply set

Z10NE02UG10

TANDEM plus BLUMOTION

Specifications

Space requirements

For opening widths **340** (13-3/8") and wider

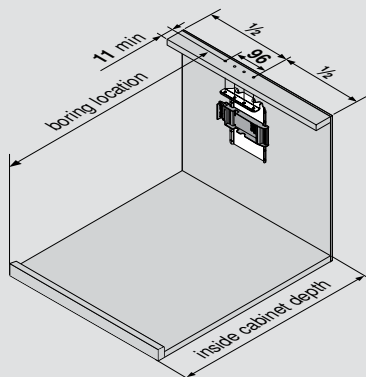

For opening widths **246 to 339** (9-11/16" – 13-3/8")

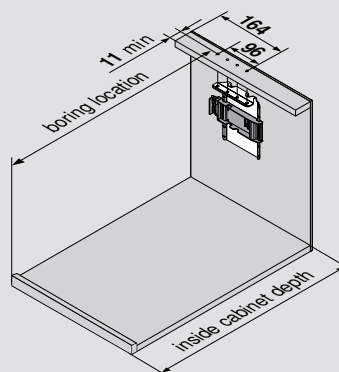

boring location requirements

drawer length	229 (9")	305 (12")	381 (15")	457 (18")	533 (21")	610 (24")	686 (27")	762 (30")
boring location	233 (9-3/16")	309 (12-3/16")	385 (15-3/16")	461 (18-3/16")	537 (21-3/16")	614 (24-3/16")	690 (27-3/16")	766 (30-3/16")
min. inside cabinet depth	270 (10-5/8")	346 (13-5/8")	422 (16-5/8")	498 (19-5/8")	574 (22-5/8")	651 (25-5/8")	727 (28-5/8")	803 (31-5/8")

NOTE: 41 (1-5/8") is required between drawer back and back panel

Boring specifications

Top boring pattern

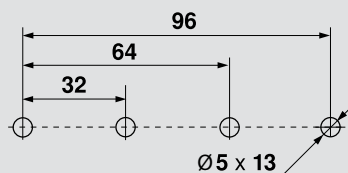

Positioning the drive unit

One drive unit can be positioned anywhere along the height of the bracket

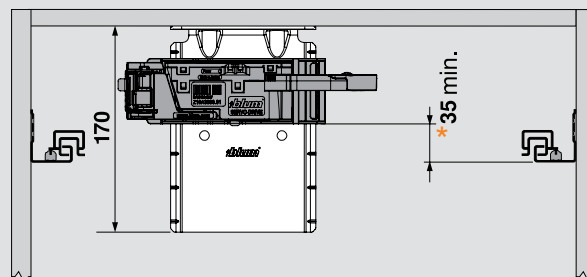

* If opening width is less than **420** (16-9/16"), drive unit should be mounted **50** (1-15/16") minimum from bottom of runner

Top bracket

Installation of top bracket with adapter

1 Feed cable into the drive unit attachment bracket

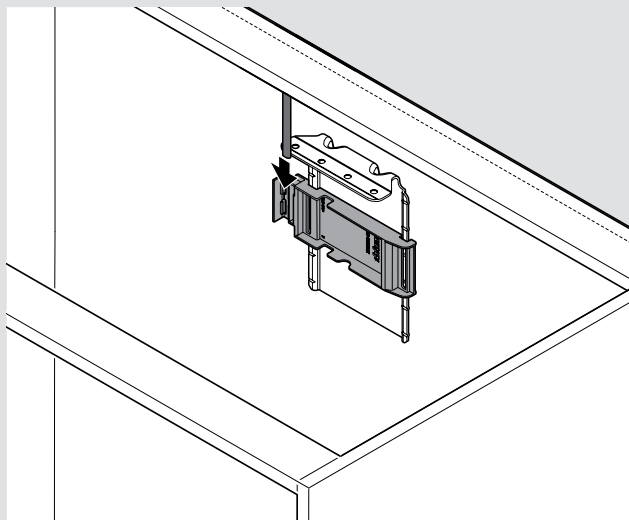

2 Secure with four system screws (661.1300.HG)

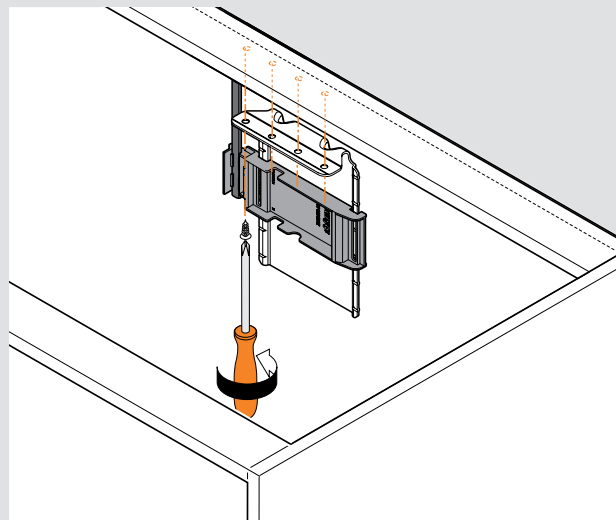

Wiring options pg 61

TANDEM plus BLUMOTION

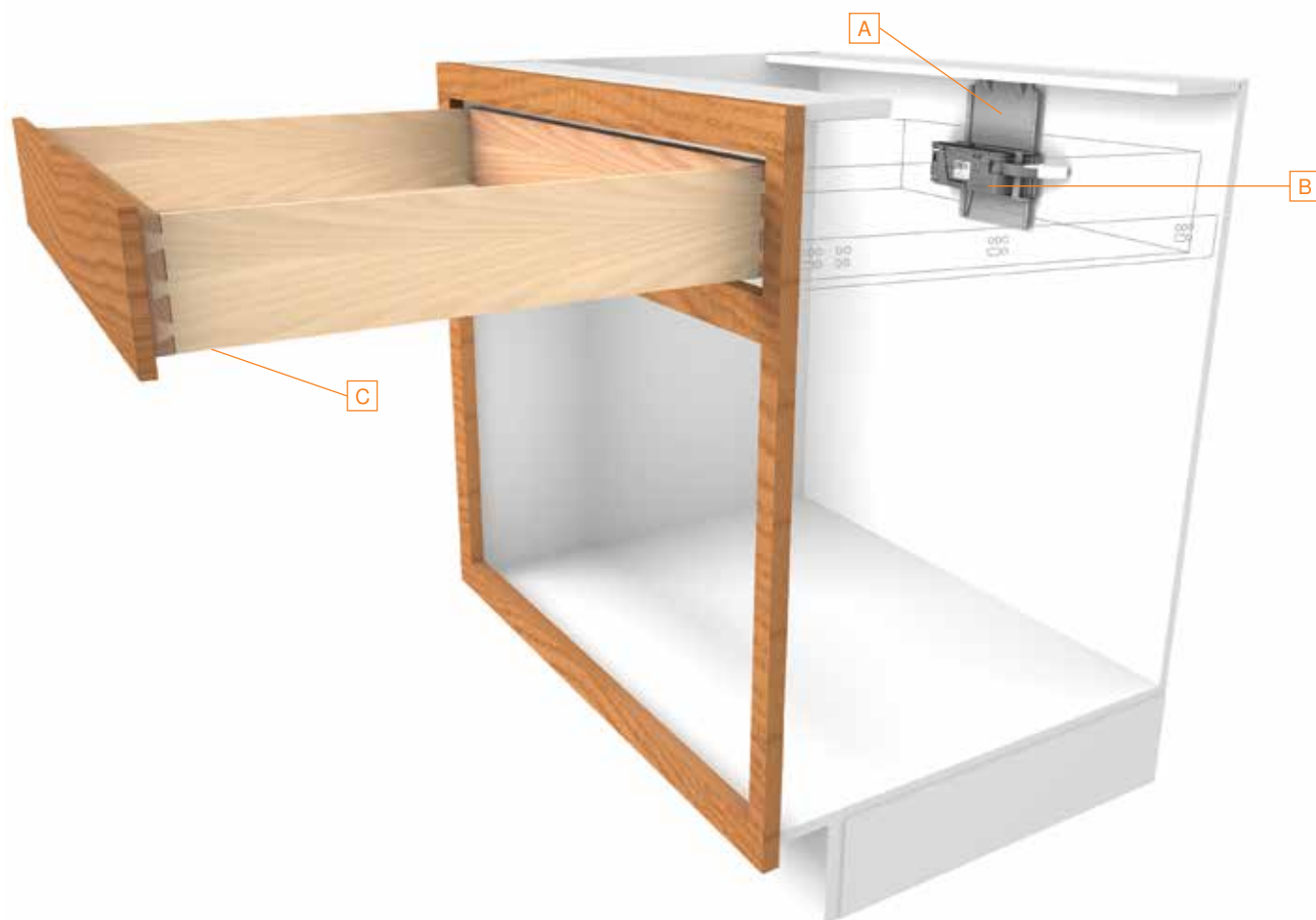

Top bracket with adapter

A

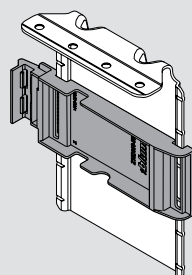

Part no.

Top bracket with adapter

Z10D6252

Installation screw

661.1300.HG

Drive unit

B

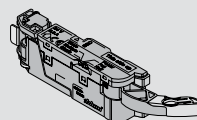

Part no.

Installation

pg 63

Drive unit

Z10A3000.02

SERVO-DRIVE locking device with integrated bumper

C

Provides 3 (1/8") gap



Part no.

SERVO-DRIVE locking device, left

T51.1901.PS L

SERVO-DRIVE locking device, right

T51.1901.PS R

Inset top bracket



Power supply set

Set includes:

- 19 ft universal cable
- 72 watt power supply
- Wall mount bracket
- Three-prong power cord
- Cable end protector (qty 3)
- INSERTA cable connector
- Cable clips (qty 10)
- Technical information

Part no.

Details

pg 57

Power supply set

Z10NE02UG10

TANDEM plus BLUMOTION

Specifications

Space requirements

For opening widths **340** (13-3/8") and wider

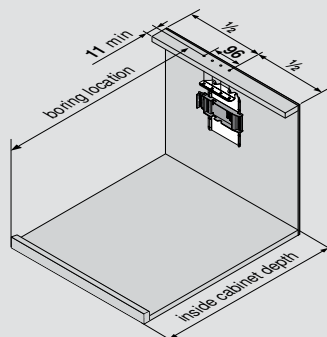

For opening widths **246 to 339** (9-11/16" – 13-3/8")

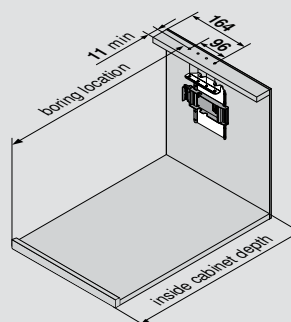

Boring specifications

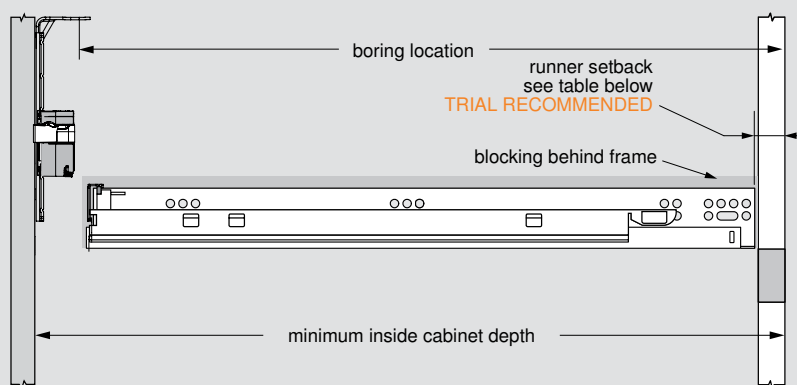

boring location requirements

boring location = drawer length + 1 (1/32") + runner setback

minimum inside cabinet depth = drawer length + 38 (1-1/2") + runner setback

Mounting the TANDEM runner for inset application

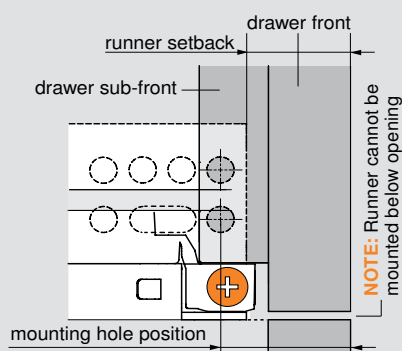

563/569 H/.		runner setback			563/569 F/A		runner setback		
sub-front thickness	13 (1/2")	20 (25/32")	23 (29/32")	26 (1-1/32")	sub-front thickness	13 (1/2")	17 (21/32")	20 (25/32")	23 (29/32")
	16 (5/8")	23 (29/32")	26 (1-1/32")	29 (1-5/32")		16 (5/8")	20 (25/32")	23 (29/32")	26 (1-1/32")
	19 (3/4")	26 (1-1/32")	29 (1-5/32")	32 (1-1/4")		19 (3/4")	23 (29/32")	26 (1-1/32")	29 (1-5/32")
		16 (5/8")	19 (3/4")	22 (7/8")			16 (5/8")	19 (3/4")	22 (7/8")
drawer front thickness					drawer front thickness				

- Setbacks in this table recess the face of the drawer front inside of the cabinet 1 (1/32")
- The depth adjustment can then be used to move the drawer front out to its desired position, 2.5 (3/32") out adjustment only

calculating runner setback

563/569 H/. (sub-front thickness + drawer front thickness minus 9 (11/32") = runner setback)

563/569 F/A (sub-front thickness + drawer front thickness minus 12 (15/32") = runner setback)

NOTE: For mounting hole position, add 7 (9/32") to runner setback

Inset top bracket

Boring specifications

Top boring pattern

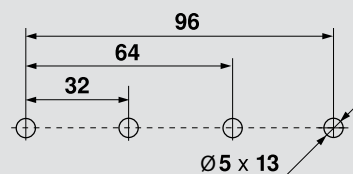

Positioning the drive unit

One drive unit can be positioned anywhere along the height of the bracket

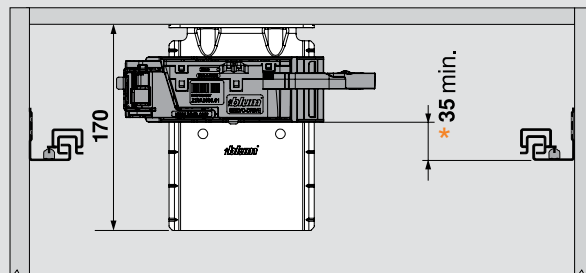

*If opening width is less than 420 (16-9/16"), drive unit should be mounted 50 (1-15/16") minimum from bottom of runner

Installation of top adapter

1 Feed cable into the drive unit attachment bracket

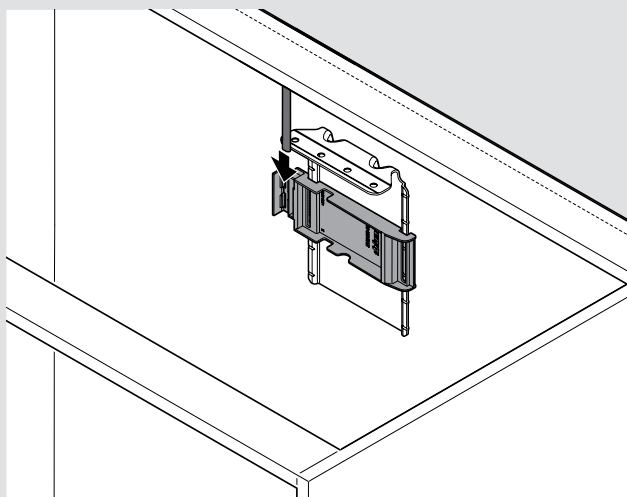

2 Secure with four system screws (661.1300.HG)

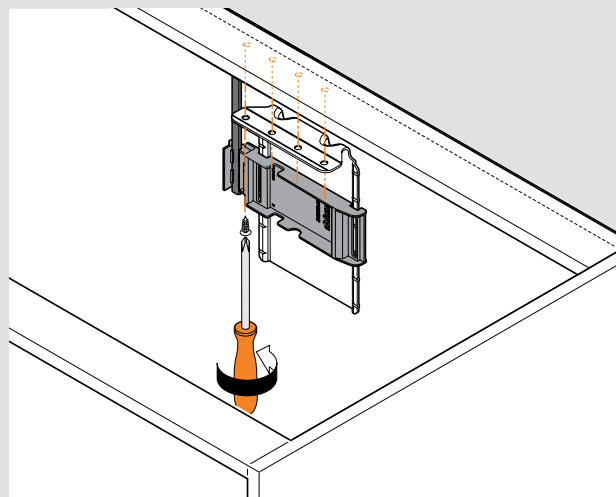

Wiring options pg 61

SERVO-DRIVE locking device with integrated bumper



- Captive right device and self-aligning left device
- Self-adjusting drawer length tolerance
- Minimum inside drawer width 170 (6-11/16")
- Height adjustment +3 (1/8")
- Side adjustment ±1.5 (1/16")
- Depth adjustment +2.5 (3/32"), preset at 0
- Minimum sub-front thickness 13 (1/2")
- Designed for 13 (1/2") drawer bottom recess
- Integrated 3 (1/8") distance bumper for inset or overlay SERVO-DRIVE applications

Installation pg 64

TANDEM plus BLUMOTION

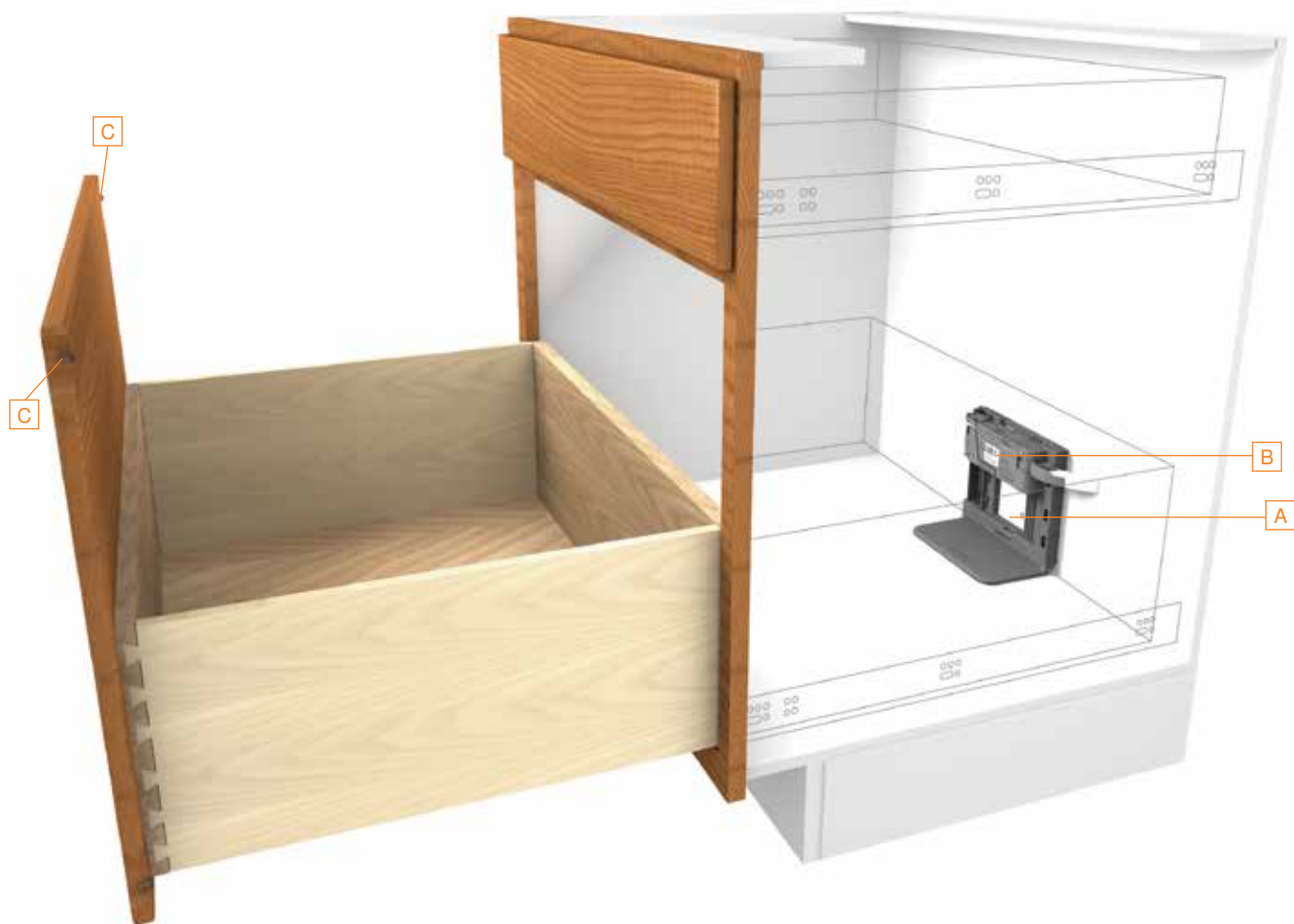

Bottom bracket

A

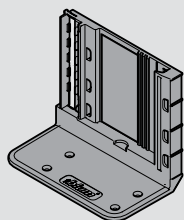

NOTE: 800 (31-1/2") universal cable is included

Part no.

Bottom bracket, double for two drive units

Z10D7201.01

Installation screw

606N or 606P

Drive unit

B

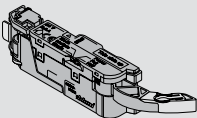

Part no.

Installation

pg 63

Drive unit

Z10A3000.02

Blum distance bumper

C Provides 3 (1/8") gap



Part no.

1 Ø5 mm bumper

993.0531

2 Screw-on bumper

993.1220

Specifications

pg 60

Bottom bracket



Waste/recycle set

Set includes:

- Adapter plate
- Drive unit (pre-attached)
- Double bottom bracket (additional drive unit can be attached)
- 110v plug-in power supply with six foot cable
- Screw-on distance bumpers (qty 4)
- INSERTA cable connector
- Mounting template and instruction sheet
- All necessary mounting screws are included

Part no.

Details

pg 56

Waste/recycle set

Z10NA20UGUS

Power supply set

Set includes:

- 19 ft universal cable
- 72 watt power supply
- Wall mount bracket
- Three-prong power cord
- Cable end protector (qty 3)
- INSERTA cable connector
- Cable clips (qty 10)
- Technical information

Part no.

Details

pg 57

Power supply set

Z10NE02UG10

TANDEM plus BLUMOTION

Specifications

Space requirements

For opening widths **340** (13-3/8") and wider

A 3D perspective diagram of a cabinet drawer assembly. A vertical back panel is shown with a drawer front attached. A horizontal line indicates the 'inside cab. depth'. Below the drawer front, two dimension lines show a total width of 1/2 inch, split into two 1/4 inch segments. A vertical dashed line points to the 'boring location' on the cabinet side panel.

For opening widths **275 to 339** (10-13/16" to 13-3/8")

A 3D perspective diagram of a cabinet drawer assembly, similar to the first one. It shows the 'inside cab. depth' and the 'boring location' on the side panel. A dimension line indicates a gap of 200 units between the drawer front and the back panel.

boring location requirements

drawer length	229 (9")	305 (12")	381 (15")	457 (18")	533 (21")	610 (24")	686 (27")	762 (30")
boring location	253 (9-15/16")	329 (12-15/16")	405 (15-15/16")	481 (18-15/16")	557 (21-15/16")	634 (24-15/16")	710 (27-15/16")	786 (30-15/16")
min. inside cabinet depth	270 (10-5/8")	346 (13-5/8")	422 (16-5/8")	498 (19-5/8")	574 (22-5/8")	651 (25-5/8")	727 (28-5/8")	803 (31-5/8")

NOTE: 41 (1-5/8") is required between drawer back and back panel

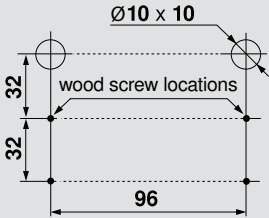
Boring specifications	
Bottom boring pattern	
	

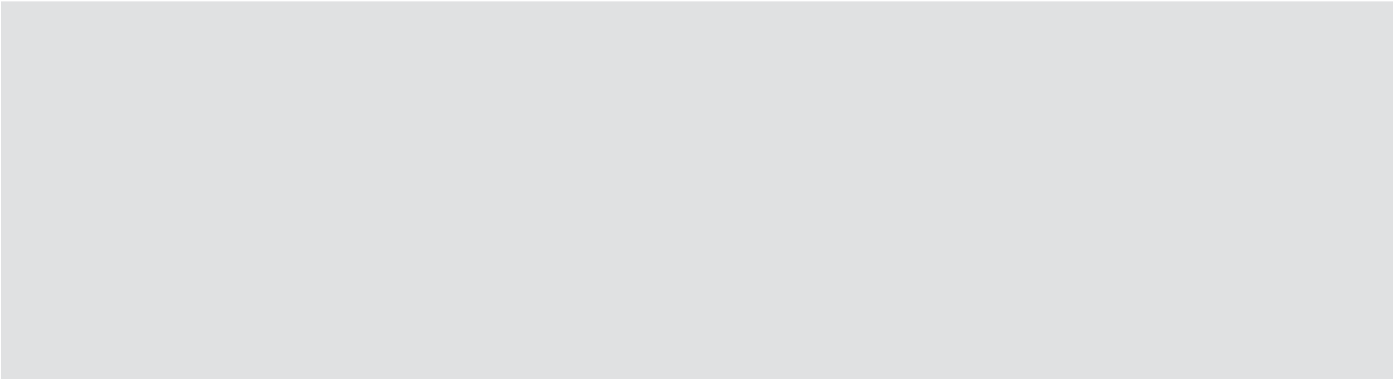
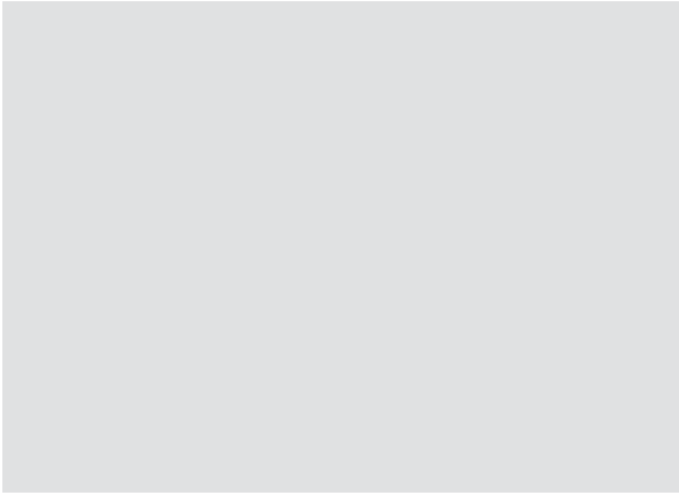

Bottom bracket

Installation of bottom bracket

1 Insert locating pins into pre-bored holes

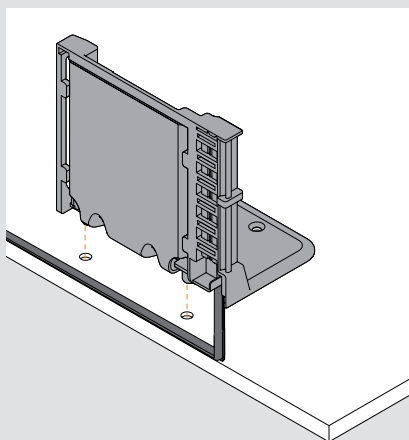

2 Secure with four wood screws (606N or 606P)

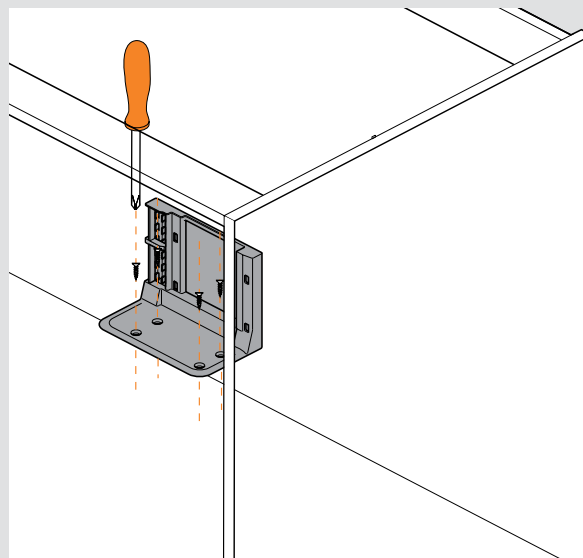

Drive unit attachment

Bottom bracket for attachment of one or two drive units

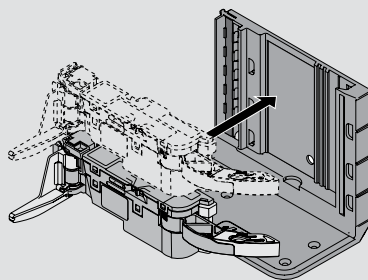

Wiring options pg 61

TANDEM plus BLUMOTION

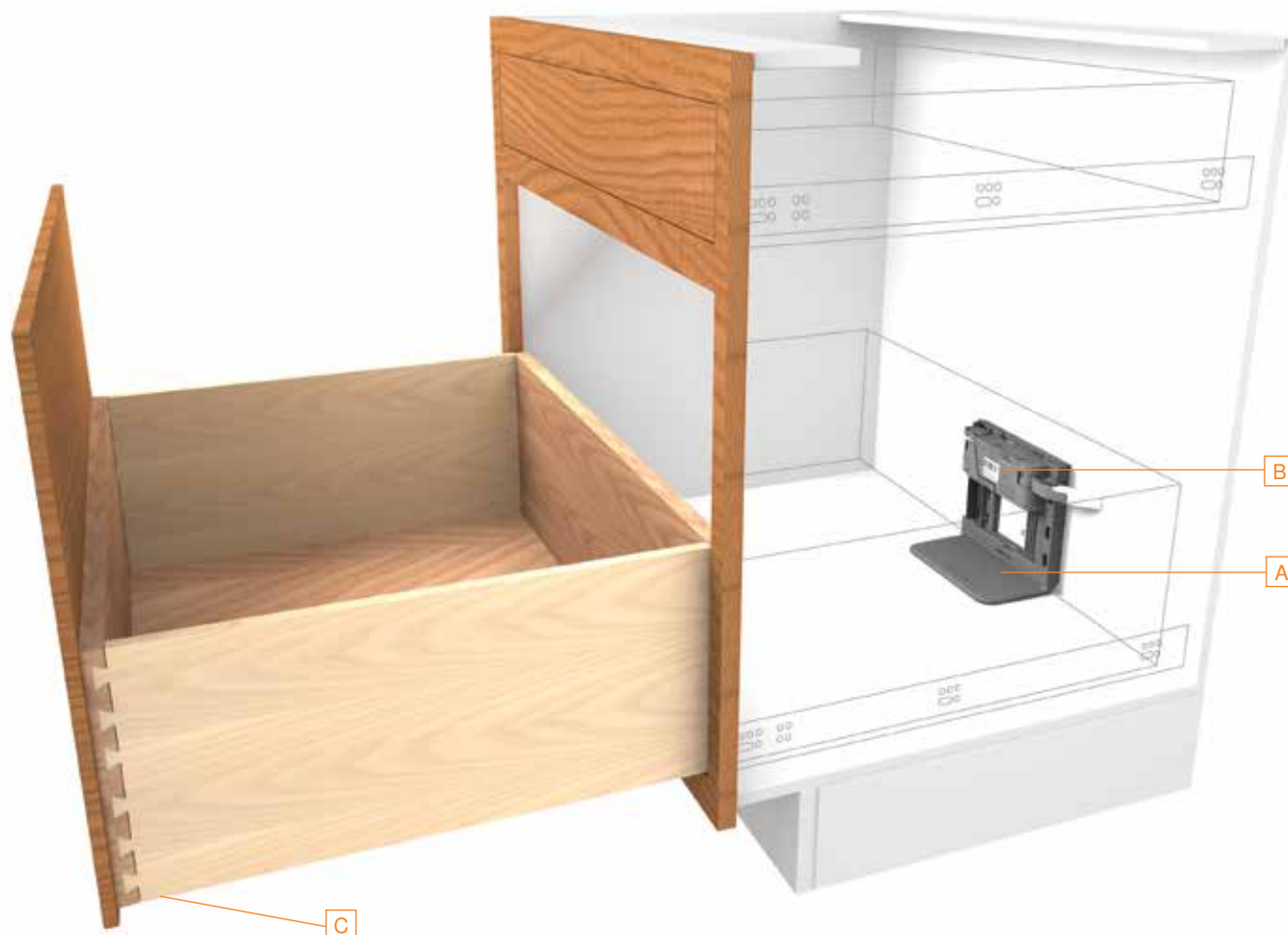

Bottom bracket

A

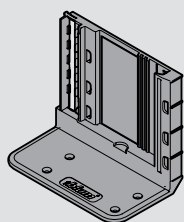

NOTE: 800 (31-1/2") universal cable is included

Part no.

Bottom bracket, double for two drive units

Z10D7201.01

Installation screw

606N or 606P

Drive unit

B

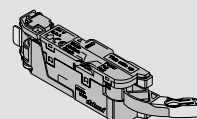

Part no.

Installation

pg 63

Drive unit

Z10A3000.02

SERVO-DRIVE locking device with integrated bumper

C

Provides 3 (1/8") gap



Part no.

SERVO-DRIVE locking device, left

T51.1901.PS L

SERVO-DRIVE locking device, right

T51.1901.PS R

Inset bottom bracket



Waste/recycle set

Set includes:

- Adapter plate
- Drive unit (pre-attached)
- Double bottom bracket (additional drive unit can be attached)
- 110v plug-in power supply with six foot cable
- Screw-on distance bumpers (qty 4)
- INSERTA cable connector
- Mounting template and instruction sheet
- All necessary mounting screws are included

Part no.

Details

pg 56

Waste/recycle set

Z10NA20UGUS

Power supply set

Set includes:

- 19 ft universal cable
- 72 watt power supply
- Wall mount bracket
- Three-prong power cord
- Cable end protector (qty 3)
- INSERTA cable connector
- Cable clips (qty 10)
- Technical information

Part no.

Details

pg 57

Power supply set

Z10NE02UG10

TANDEM plus BLUMOTION

Specifications

Space requirements

For opening widths **340** (13-3/8") and wider

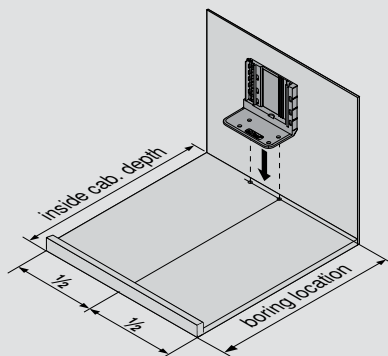

For opening widths **275 to 339** (10-13/16" – 13-3/8")

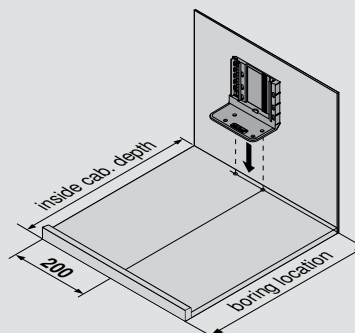

Boring specifications

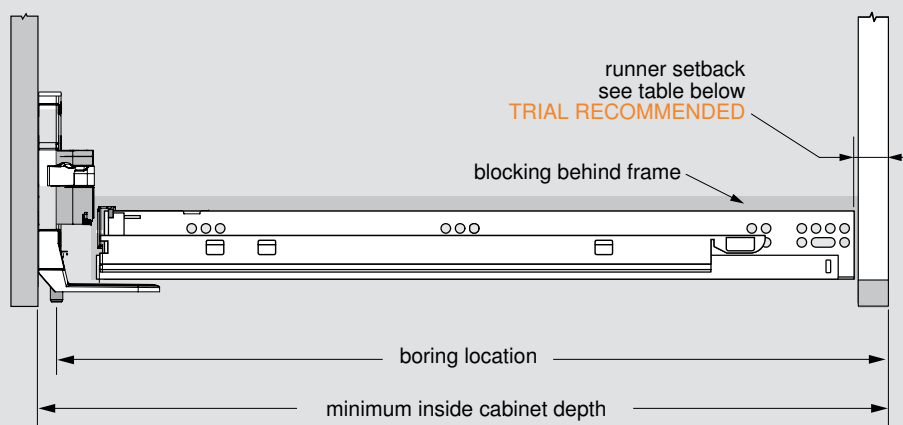

boring location requirements

boring location = drawer length + **21** (13/16") + runner setback

minimum inside cabinet depth = drawer length + **38** (1-1/2") + runner setback

Mounting the TANDEM runner for inset application

		563/569 H/.	runner setback			563/569 F/A	runner setback			
	sub-front thickness	13 (1/2")	20 (25/32")	23 (29/32")	26 (1-1/32")	sub-front thickness	13 (1/2")	17 (21/32")	20 (25/32")	23 (29/32")
		16 (5/8")	23 (29/32")	26 (1-1/32")	29 (1-5/32")		16 (5/8")	20 (25/32")	23 (29/32")	26 (1-1/32")
		19 (3/4")	26 (1-1/32")	29 (1-5/32")	32 (1-1/4")		19 (3/4")	23 (29/32")	26 (1-1/32")	29 (1-5/32")
			16 (5/8")	19 (3/4")	22 (7/8")			16 (5/8")	19 (3/4")	22 (7/8")
		drawer front thickness				drawer front thickness				

- Setbacks in this table recess the face of the drawer front inside of the cabinet **1** (1/32")
- The depth adjustment can then be used to move the drawer front out to its desired position, **2.5** (3/32") out adjustment only

calculating runner setback

563/569 H/. (sub-front thickness + drawer front thickness minus **9** (11/32") = runner setback)

563/569 F/A (sub-front thickness + drawer front thickness minus **12** (15/32") = runner setback)

NOTE: For mounting hole position, add **7** (9/32") to runner setback

Inset bottom bracket

Boring specifications

Bottom boring pattern

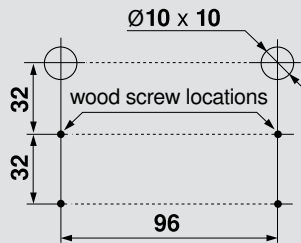

SERVO-DRIVE locking device with integrated bumper



- Captive right device and self-aligning left device
- Self-adjusting drawer length tolerance
- Minimum inside drawer width **170** (6-11/16")
- Height adjustment **+3** (1/8")
- Side adjustment **±1.5** (1/16")
- Depth adjustment **+2.5** (3/32"), preset at **0**
- Minimum sub-front thickness **13** (1/2")
- Designed for **13** (1/2") drawer bottom recess
- Integrated **3** (1/8") distance bumper for inset or overlay SERVO-DRIVE applications

Installation pg 64

Installation of bottom bracket

- 1 Insert locating pins into pre-bored holes

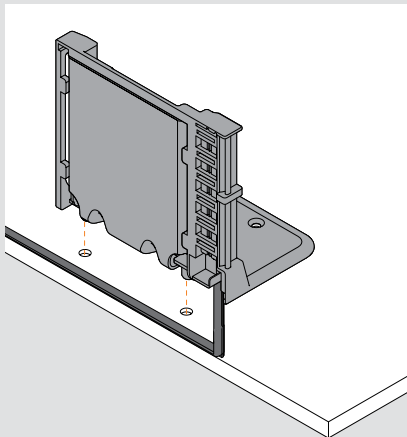

- 2 Secure with four wood screws (606N or 606P)

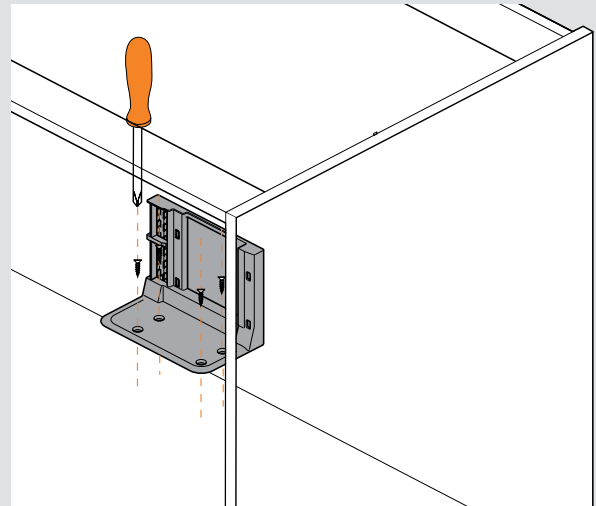

Drive unit attachment

Bottom bracket for attachment of one or two drive units

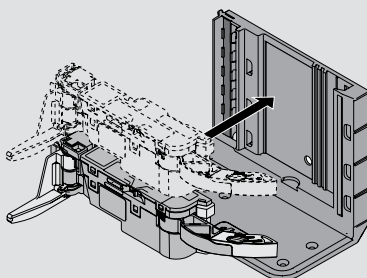

Wiring options pg 61

TANDEM inset spacer

For applications where there would not be enough space behind the drawer box to add SERVO-DRIVE due to cabinet construction, plumbing, etc. Two required per drawer.

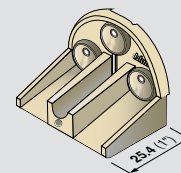

Part no.

TANDEM spacer

T59.A5P0S

Installation screw

606N or 606P

TANDEMBOX



Vertical aluminum profile

A Profile can be cut to size

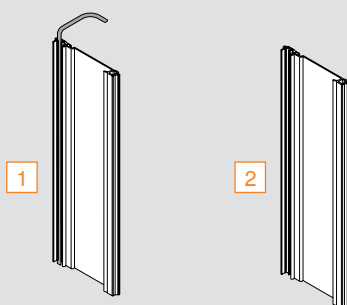

*cable length 800 (31-1/2")

Part no.

1 Profile with cable, length 720 (28-3/8")*

Z10T720AB

1 Profile without cable, length 1170 (46")

Z10T1170A

Top and bottom adapter set

B For use with horizontal stretcher rail

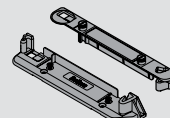

Part no.

Top and bottom adapter set

Z10D01E0.01

Back and bottom adapter set

B For use with back stretcher rail

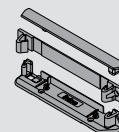

Part no.

Back and bottom adapter set with cover cap

Z10D01EA.01

Vertical aluminum profile



Drive unit

C

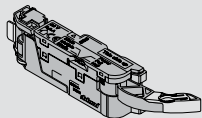

Part no.

Installation

pg 63

Drive unit

Z10A3000.02

Blum distance bumper

D

Provides 3 (1/8") gap

1



2



Part no.

1 Ø5 mm bumper

993.0531

2 Screw-on bumper

993.1220

Specifications

pg 60

Power supply set

Set includes:

- 19 ft universal cable
- 72 watt power supply
- Wall mount bracket
- Three-prong power cord
- Cable end protector (qty 3)
- INSERTA cable connector
- Cable clips (qty 10)
- Technical information

Part no.

Details

pg 57

Power supply set

Z10NE02UG10

TANDEMBOX top and bottom adapter

Specifications

Space requirements

For opening widths **420** (16-9/16") and wider

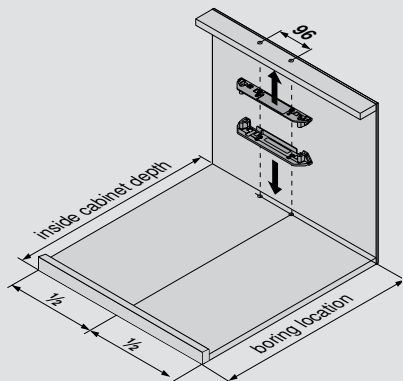

For opening widths **275** to **419** (10-13/16" – 16-1/2")

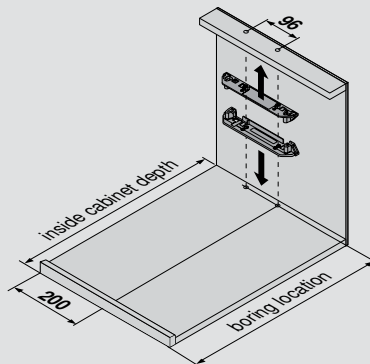

boring location requirements

profile length	270 (10-5/8")	350 (13-3/4")	400 (15-3/4")	450 (17-11/16")	500 (19-11/16")	550 (21-5/8")	600 (23-5/8")	650 (25-9/16")
boring location	289 (11-3/8")	369 (14-1/2")	419 (16-1/2")	469 (18-7/16")	519 (20-7/16")	569 (22-3/8")	619 (24-3/8")	669 (26-5/16")
min. inside cabinet depth	306 (12-1/16")	386 (15-3/16")	436 (17-3/16")	486 (19-1/8")	536 (21-1/8")	586 (23-1/16")	636 (25-1/16")	686 (27")

NOTE: 41 (1-5/8") is required between drawer back and back panel

Boring specifications

Top and bottom boring pattern

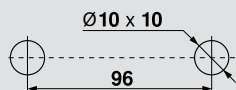

Calculating vertical profile length

Profile length = inside cabinet height minus **19** (3/4")

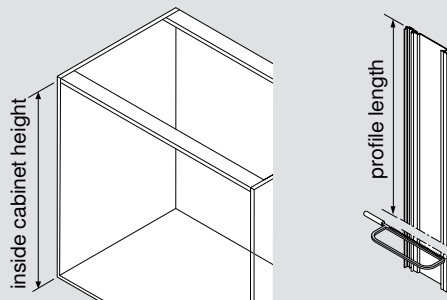

Installing vertical aluminum profile

- 1 Set profile onto bottom adapter
- 2 Push profile toward left side while engaging top
- 3 Push back on right side and snap into place

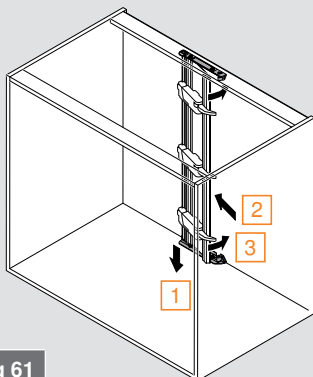

Wiring options **pg 61**

Positioning the drive unit

Lever arm should contact center of drawer back

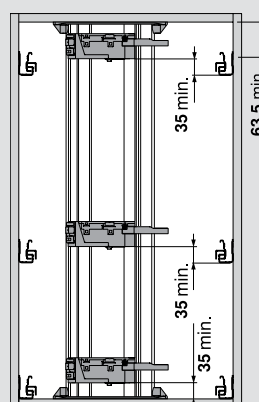

TANDEMBOX back and bottom adapter

Specifications

Space requirements

For opening widths **420** (16-9/16") and wider

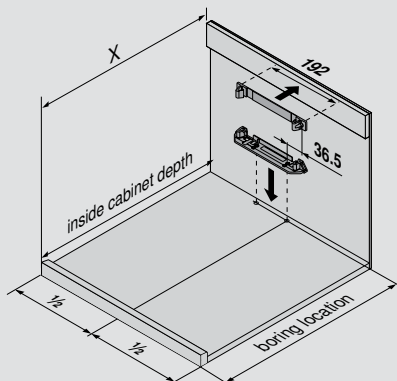

For opening widths **275 to 419** (10-13/16" – 16-1/8")

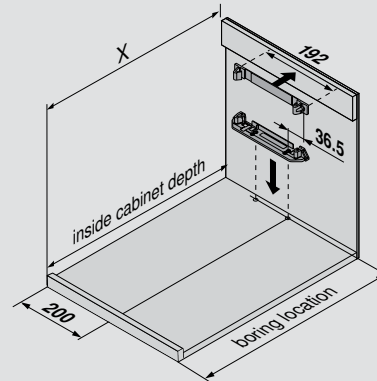

X is same as boring location

boring location requirements

profile length	270 (10-5/8")	350 (13-3/4")	400 (15-3/4")	450 (17-11/16")	500 (19-11/16")	550 (21-5/8")	600 (23-5/8")	650 (25-9/16")
X and boring location	289 (11-3/8")	369 (14-1/2")	419 (16-1/2")	469 (18-7/16")	519 (20-7/16")	569 (22-3/8")	619 (24-3/8")	669 (26-5/16")
min. inside cabinet depth	306 (12-1/16")	386 (15-3/16")	436 (17-3/16")	486 (19-1/8")	536 (21-1/8")	586 (23-1/16")	636 (25-1/16")	686 (27")

NOTE: 41 (1-5/8") is required between drawer back and back panel

Boring specifications

Back screw positioning

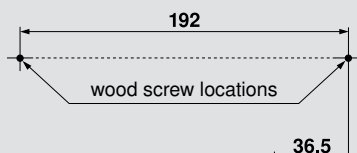

Bottom boring pattern

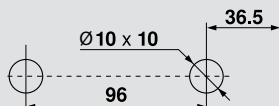

Determining vertical profile length

Profile length is dependent upon back adapter location

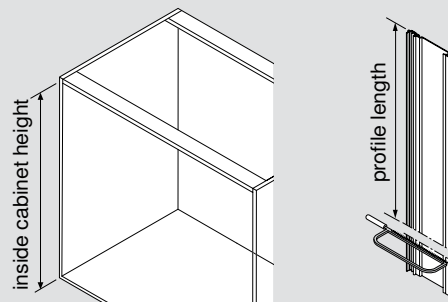

Installing vertical aluminum profile

- 1 Set profile onto bottom adapter
- 2 Push profile toward back while engaging adapter
- 3 Snap cover cap onto top of profile

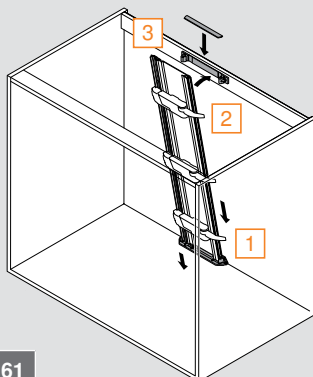

Wiring options pg 61

Positioning the drive unit

Lever arm should contact center of drawer back

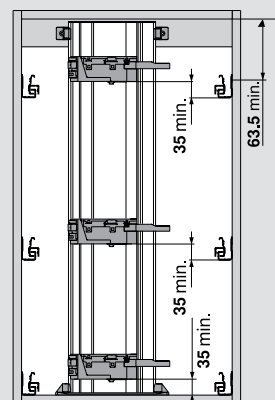

TANDEMBOX

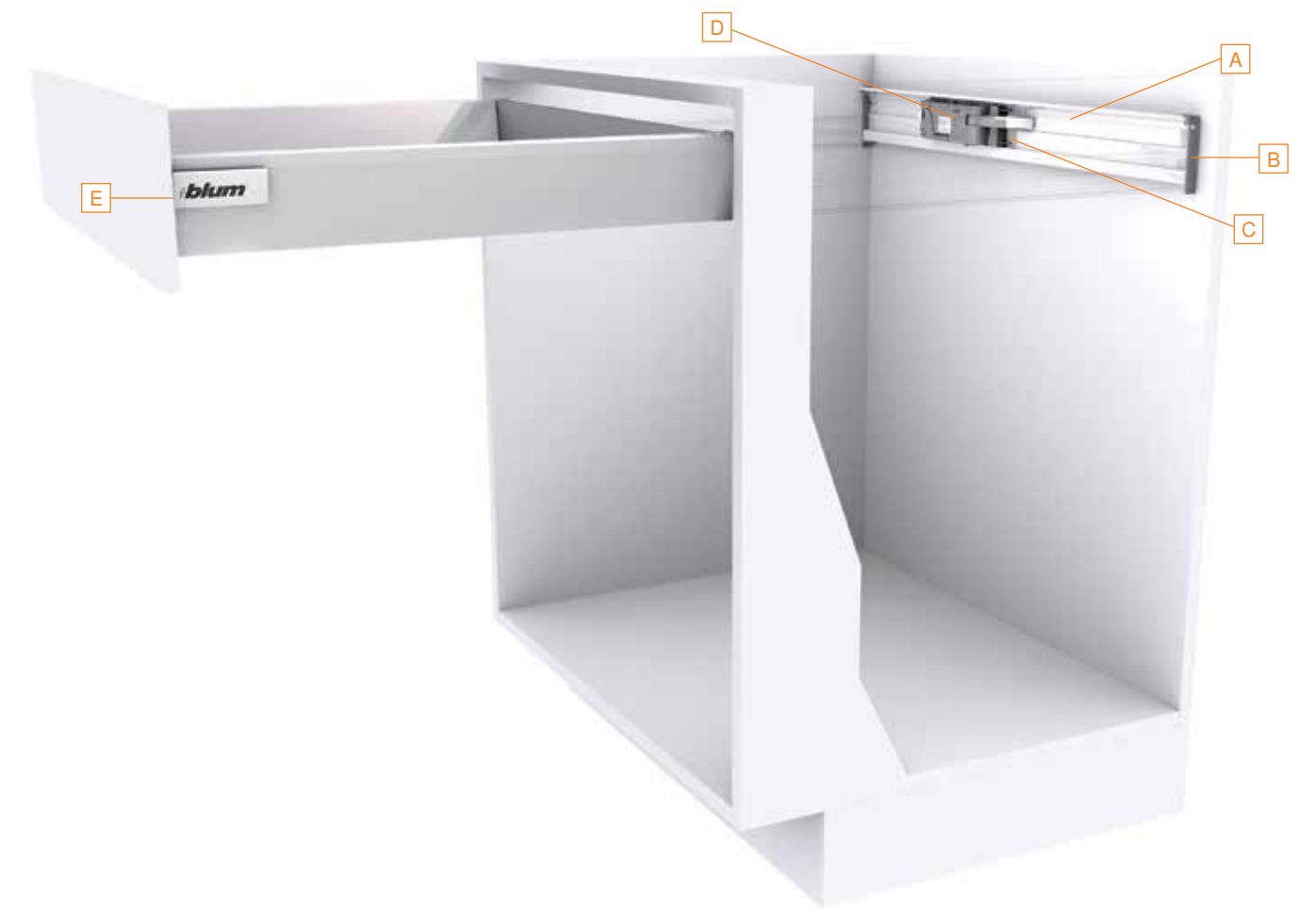

Horizontal aluminum profile

A

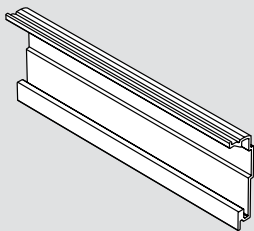

Part no.

Profile length **1143** (45"), cut to size

Z10T1143B

Adapter set for horizontal aluminum profile, panel

Set includes:

- Panel adapters (left and right)
- Profile adapter
- Installation template

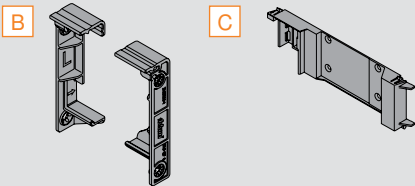

Part no.

Adapter set for horizontal profile, panel

Z10D5210.US

Installation wood screw

606N or 606P

Installation system screw

661.1300.HG

Horizontal aluminum profile



Drive unit

D

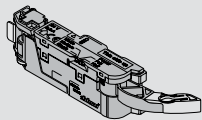

Part no.

Installation

pg 63

Drive unit

Z10A3000.02

Blum distance bumper

E

Provides 3 (1/8") gap



Part no.

1 Ø5 mm bumper

993.0531

2 Screw-on bumper

993.1220

Specifications

pg 60

Power supply set

Set includes:

- 19 ft universal cable
- 72 watt power supply
- Wall mount bracket
- Three-prong power cord
- Cable end protector (qty 3)
- INSERTA cable connector
- Cable clips (qty 10)
- Technical information

Part no.

Details

pg 57

Power supply set

Z10NE02UG10

TANDEMBOX

Specifications

Space requirements

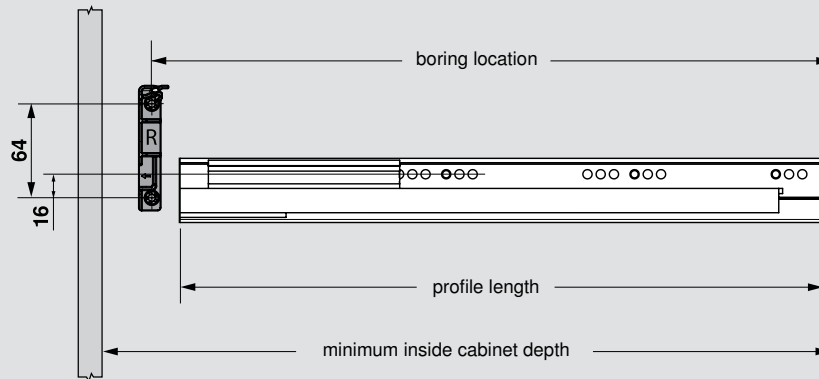

boring location requirements

profile length	270 (10-5/8")	350 (13-3/4")	400 (15-3/4")	450 (17-11/16")	500 (19-11/16")	550 (21-5/8")	600 (23-5/8")	650 (25-9/16")
boring location	297 (11-11/16")	377 (14-13/16")	427 (16-13/16")	477 (18-3/4")	527 (20-3/4")	577 (22-11/16")	627 (24-11/16")	677 (26-5/8")
min. inside cabinet depth	306 (12-1/16")	386 (15-3/16")	436 (17-3/16")	486 (19-1/8")	536 (21-1/8")	586 (23-1/16")	636 (25-1/16")	686 (27")

NOTE: 41 (1-5/8") is required between drawer back and back panel

Mounting of adapters

- 1 Set cardboard template onto runner
- 2 Mark hole position

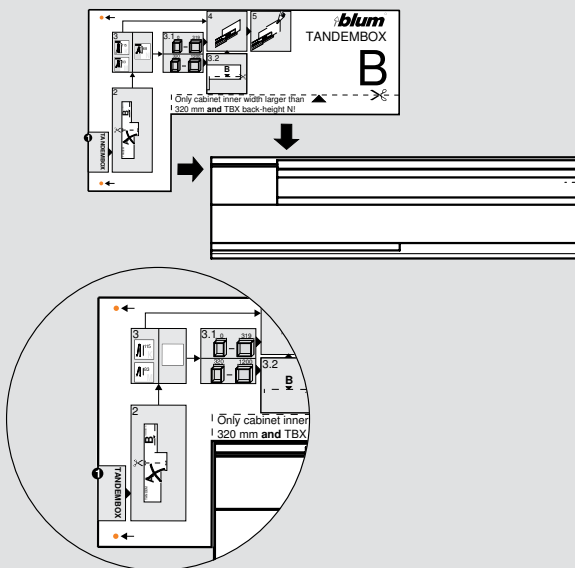

- 3 Attach with four wood screws (606N or 606P) or four system screws (661.1300.HG)

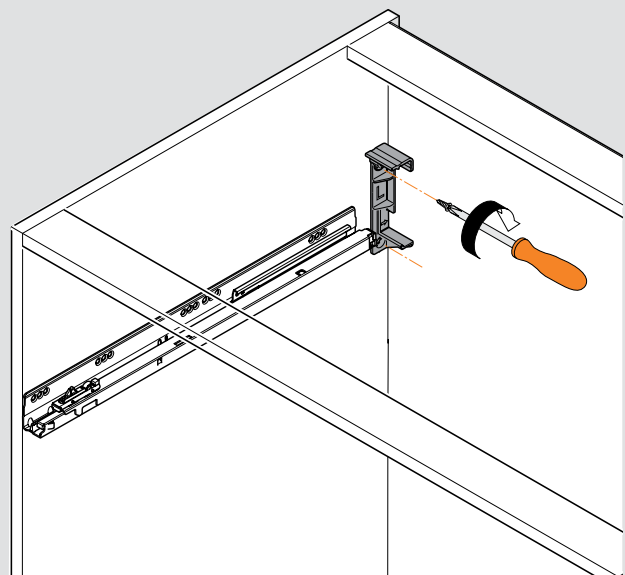

Horizontal aluminum profile

Calculating horizontal profile size

Profile length = interior cabinet opening minus 19 (3/4")

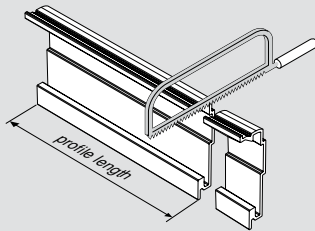

Installing profile adapter onto horizontal profile

- 1 Place bottom of profile adapter into the bottom slot of profile

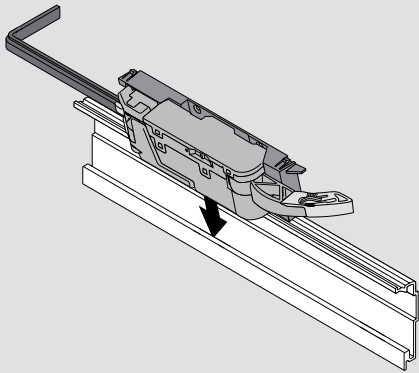

- 2 Push top of profile adapter toward the back of the profile and snap into place

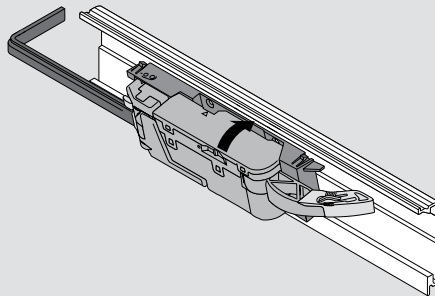

- 3 Align cable along bottom slot of profile

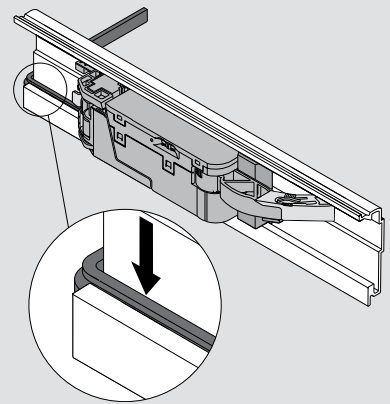

Installing horizontal profile into adapters

- 1 Slide cable through the notch in the adapter
- 2 Push horizontal profile toward bottom
- 3 Slide profile toward left adapter
- 4 Push top of profile to snap into adapter

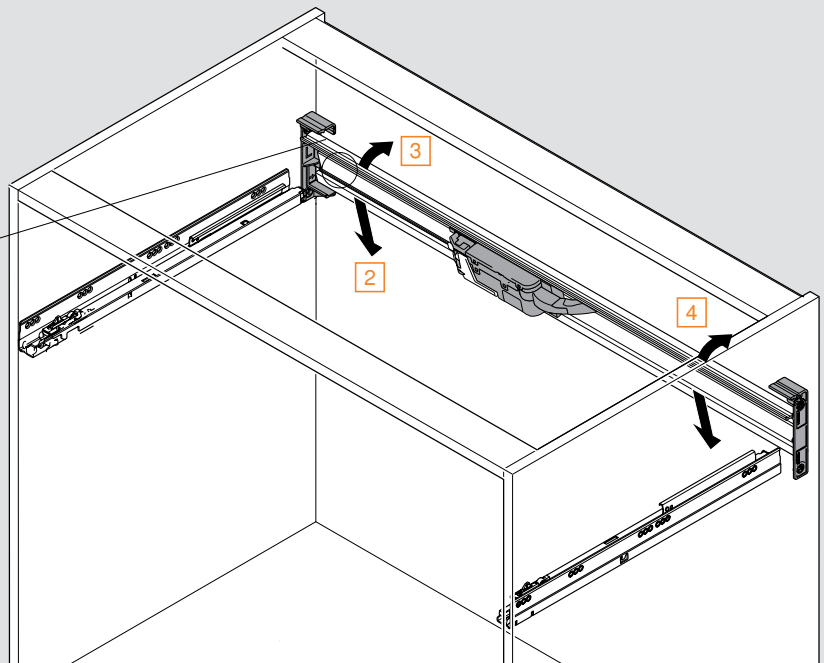
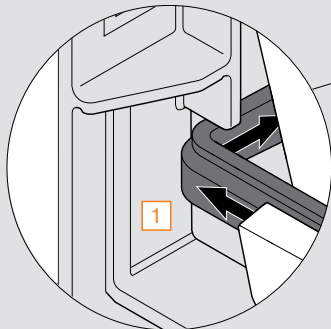

Wiring options pg 61

TANDEMBOX



Top bracket with adapter

A

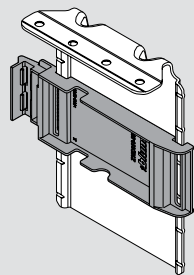

Part no.

Top bracket with adapter

Z10D6252

Installation screw

661.1300.HG

Drive unit

B

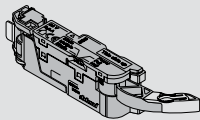

Part no.

Installation

pg 63

Drive unit

Z10A3000.02

Blum distance bumper

C Provides 3 (1/8") gap

1



2



Part no.

1 Ø5 mm bumper

993.0531

Specifications

pg 60

2 Screw-on bumper

993.1220

Top bracket



Power supply set

Set includes:

- 19 ft universal cable
- 72 watt power supply
- Wall mount bracket
- Three-prong power cord
- Cable end protector (qty 3)
- INSERTA cable connector
- Cable clips (qty 10)
- Technical information

Part no.

Details

pg 57

Power supply set

Z10NE02UG10

TANDEMBOX

Specifications

Space requirements

For opening widths **420** (16-9/16") and wider

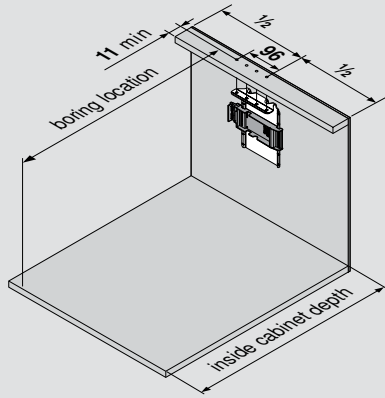

For opening widths **275 to 419** (10-13/16" – 16-1/2") wide

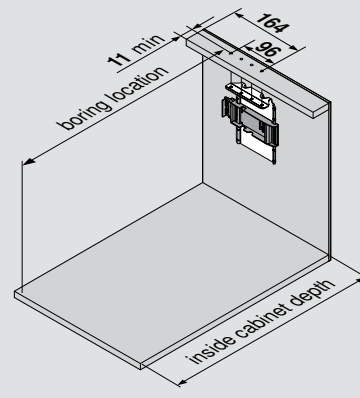

boring location requirements

profile length	270 (10-5/8")	350 (13-3/4")	400 (15-3/4")	450 (17-11/16")	500 (19-11/16")	550 (21-5/8")	600 (23-5/8")	650 (25-9/16")
boring location	269 (10-9/16")	349 (13-3/4")	399 (15-11/16")	449 (17-11/16")	499 (19-5/8")	549 (21-5/8")	599 (23-9/16")	649 (25-9/16")
min. inside cabinet depth	303 (11-15/16")	383 (15-1/16")	433 (17-1/16")	483 (19")	533 (21")	583 (22-15/16")	633 (24-15/16")	683 (26-7/8")

NOTE: 41 (1-5/8") is required between drawer back and back panel

Boring specifications

Top boring pattern

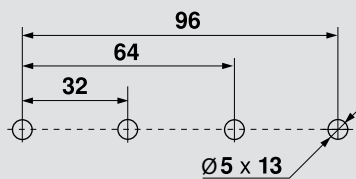

Positioning the drive unit

One drive unit can be positioned anywhere along the height of the bracket

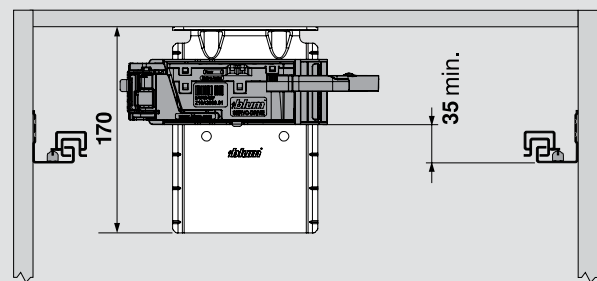

Top bracket

Installation of top adapter

1 Feed cable into the drive unit attachment bracket

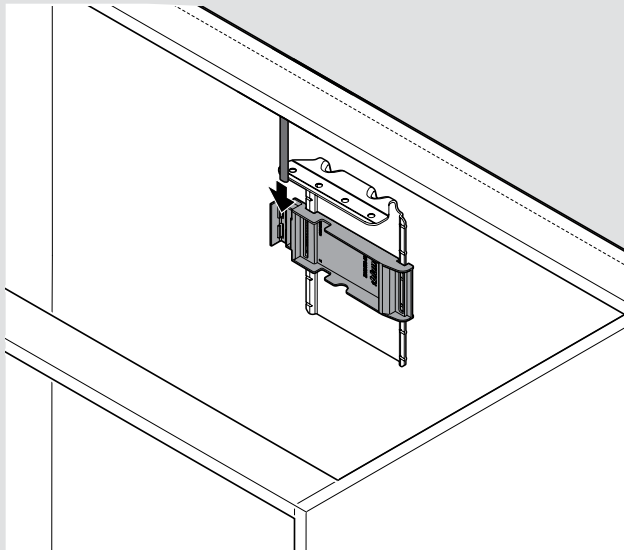

2 Secure with four system screws (661.1300.HG)

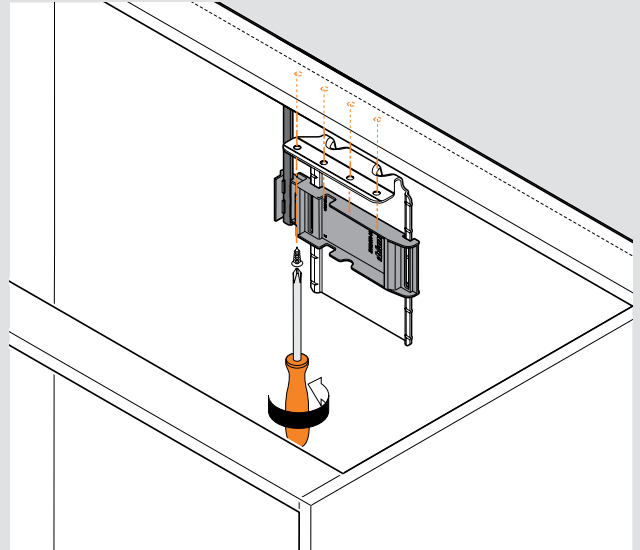

Wiring options pg 61

TANDEMBOX



Bottom bracket

A

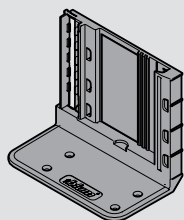

NOTE: 800 (31-1/2") universal cable is included

Part no.

Bottom bracket, double for two drive units

Z10D7201.01

Installation screw

606N or 606P

Drive unit

B

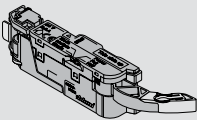

Part no.

Installation

pg 63

Drive unit

Z10A3000.02

Blum distance bumper

C Provides 3 (1/8") gap



Part no.

1 Ø5 mm bumper

993.0531

2 Screw-on bumper

993.1220

Specifications

pg 60

Bottom bracket



Waste/recycle set

Set includes:

- Adapter plate
- Drive unit (pre-attached)
- Double bottom bracket (additional drive unit can be attached)
- 110v plug-in power supply with six foot cable
- Screw-on distance bumpers (qty 4)
- INSERTA cable connector
- Mounting template and instruction sheet
- All necessary mounting screws are included

Part no.

Details

pg 56

Waste/recycle set

Z10NA20UGUS

Power supply set

Set includes:

- 19 ft universal cable
- 72 watt power supply
- Wall mount bracket
- Three-prong power cord
- Cable end protector (qty 3)
- INSERTA cable connector
- Cable clips (qty 10)
- Technical information

Part no.

Details

pg 57

Power supply set

Z10NE02UG10

TANDEMBOX

Specifications

Space requirements

For opening widths **420** (16-9/16") and wider

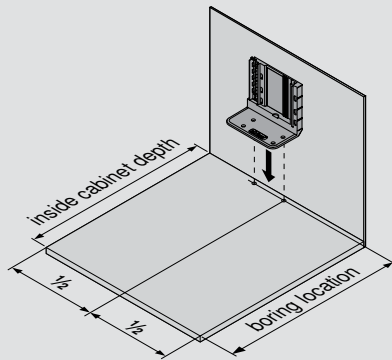

For opening widths **275 to 419** (10-13/16" – 16-1/2") wide

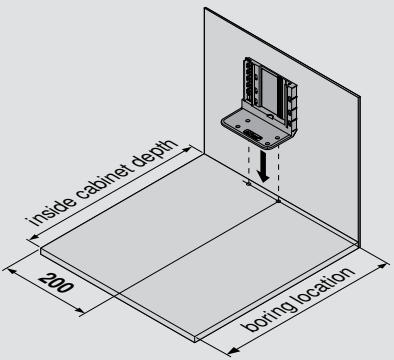

boring location requirements

profile length	270 (10-5/8")	350 (13-3/4")	400 (15-3/4")	450 (17-11/16")	500 (19-11/16")	550 (21-5/8")	600 (23-5/8")	650 (25-9/16")
boring location	289 (11-3/8")	369 (14-1/2")	419 (16-1/2")	469 (18-7/16")	519 (20-7/16")	569 (22-3/8")	619 (24-3/8")	669 (26-5/16")
min. inside cabinet depth	306 (12-1/16")	386 (15-3/16")	436 (17-3/16")	486 (19-1/8")	536 (21-1/8")	586 (23-1/16")	636 (25-1/16")	686 (27")

NOTE: 41 (1-5/8") is required between drawer back and back panel

Boring specifications

Bottom boring pattern

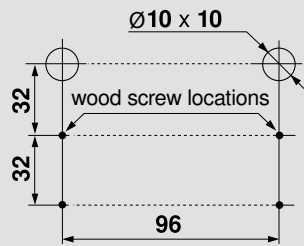

Bottom bracket

Installation of bottom bracket

1 Insert locating pins into pre-bored holes

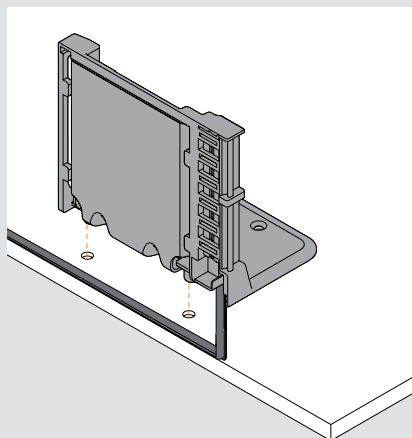

2 Secure with four wood screws (606N or 606P)

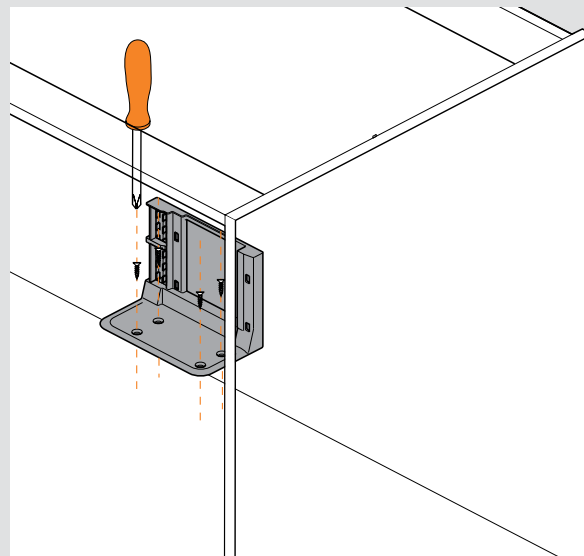

Drive unit attachment

Bottom bracket for attachment of one or two drive units

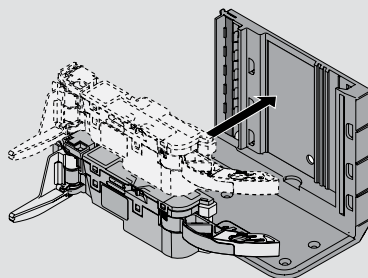

Wiring options pg 61

Waste/recycle set

Everything you need

The waste/recycle set contains all necessary SERVO-DRIVE components for this application including technical information and cardboard boring templates. This makes order processing easy. One part number is all that is required. The installer has everything necessary for installation.

Easy installation

SERVO-DRIVE is quick and easy to install in waste/recycle applications. In addition, all SERVO-DRIVE components are maintenance free and comply with all safety standards.

For more information and specifications on TANDEM, TANDEMBOX and SERVO-DRIVE waste/recycle sets please see the Waste/recycle set brochure.

TANDEMBOX



TANDEM



SERVO-DRIVE waste/recycle set

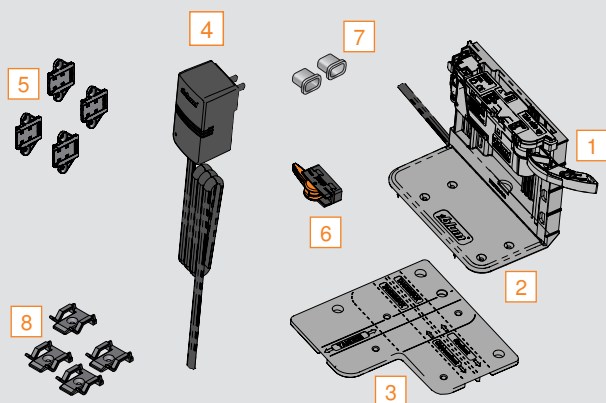

Set includes:

- 1 Drive unit (pre-attached)
- 2 Double bottom bracket with #6 x 1" wood screws (qty 2)
- 3 Adapter plate
- 4 110 volt plug-in power supply with six foot of universal cable
- 5 Screw-on distance bumpers (qty 4) with #6 x 5/8" wood screws for installation (qty 2)
- 6 INSERTA cable connector
- 7 Cable end protectors (qty 2)
- 8 Cable clips (qty 4)
- Installation template, instructions and user manual

Part no.

SERVO-DRIVE waste/recycle set

Z10NA20UGUS

NOTE: Power supply will operate up to two drive units in a double bottom bracket application (second drive unit sold separately)

Power supply set

One or two sets: based on your kitchen layout

One or two power supply sets may be needed depending on your kitchen layout. When the cabinets are placed directly next to each other, one set may be enough. Two sets are required for an island kitchen or a double row "galley" kitchen.

Various kitchen layouts

One power supply set:

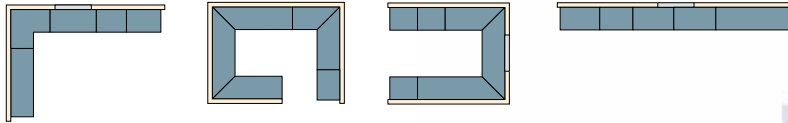

L shaped

G shaped

U shaped

Line

Two power supply sets:

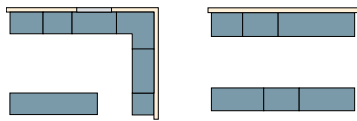

L with island

Galley



Power supply components

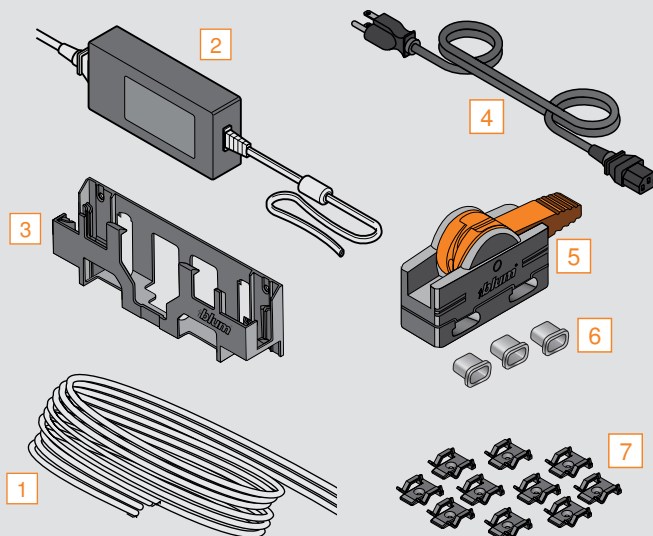

Supplies power to the drive units

Set includes:

- 1 19 ft universal cable
- 2 72 watt power supply
- 3 Wall mount bracket
- 4 Three-prong cord
- 5 INSERTA cable connector
- 6 Cable end protector (qty 3)
- 7 Cable clips (qty 10)
- Installation template, instructions and user manual

Part no.

Power supply set

Z10NE02UG10

Electrical components

SERVO-DRIVE power supply

Components



Supplies power to the drive units

- Energy Star Certified
- UL certified
- Can power up to 20 drive units
- Connect to switched GFCI outlet
- Cable length is six foot

NOTE: Three-prong power cord required

Part no.

Power supply

Z10NE020G

Specifications

Input specifications

Input voltage	100-240 VAC
Input frequency	50-60 Hz
Input current	1.7 A
Inrush current	100 A maximum at 240 VAC
Protection class	Class I
Earth leakage current	3.5 mA maximum

General specifications

Efficiency	≥ 87%
Switching frequency	65 kHz
No load loss (standby)	< 0.5 W
Energy Star	Level V

Safety / Approvals

EN / IEL	60950, 60335-1
UL	60950-1, 1310

Output specifications

Output voltage	24 VDC
Output power max.	72 W
Minimum load	None
Load regulation	2%
Ripple and noise	1% peak-to-peak maximum
Over voltage protection	At 33 VDC
Overload protection	10.5 A hiccup trip and restart mode with auto recovery
Short circuit protection	Continuous

Environmental information

Operating temperature	32° F to 104° F normal, derate from full capacity to 75% capacity from 104° F to 140° F
Storage temperature	-4° F to 185° F
Protection	IP40

Wall mount bracket for power supply

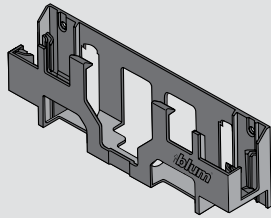

Installation **pg 63**

Part no.

Wall mount bracket

Z10NG120

Installation screw

606N or 606P

Power cord with three-prong plug

Must be plugged into a switched GFCI outlet

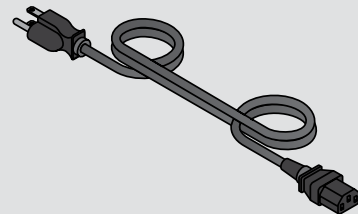

Part no.

Power cord with three-prong plug

Z10M200U

INSERTA cable connector

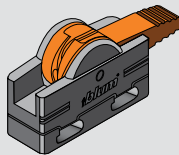

Installation **pg 62**

Part no.

INSERTA cable connector

Z10V1000.01

Cable clip

Adhesive back and/or screw-on

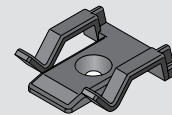

Part no.

Cable clip

Z10K0009

Installation screw

606N or 606P

INSERTA cable connector set

Set includes:

- INSERTA cable connector
- Cable end protector (qty 2)

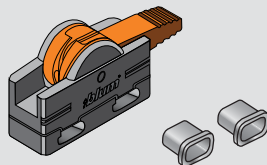

Part no.

Cable connector set

Z10V100E.01

Synchronization cables

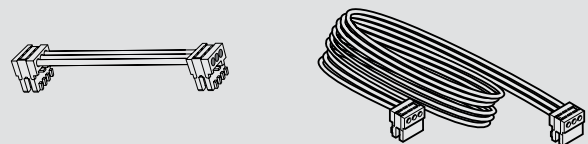

Installation **pg 64**

Part no.

80 (3') synchronization cable

Z10K008S

1200 (4') synchronization cable

Z10K120S

Universal cable

Length 26 ft with five cable end protectors

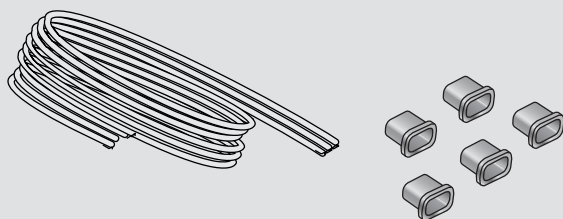

Part no.

Universal cable

Z10K800AE

Distance bumpers

Drawer front distance bumper

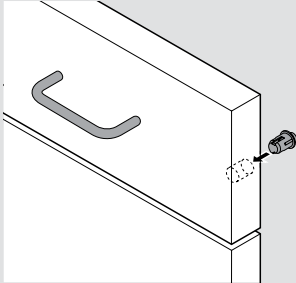

- For drawer heights **305** (12") or less two distance bumpers are required
- Center bumpers vertically left/right side of drawer front
- For drawer heights **305** (12") and greater four distance bumpers are required

drawer front height < 305

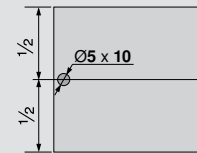

drawer front height > 305

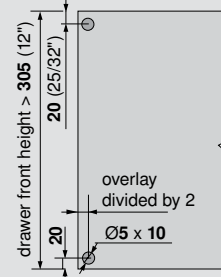

NOTE: Blum distance bumpers provide a travel of **3** (1/8")

Part no.

Ø5 mm bumper

993.0531

Screw-on distance bumper

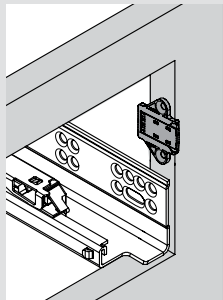

- For use with face frame or panel cabinets
- Can be mounted to side or bottom of cabinet opening
- Pre-bore with Ø2.5 mm drill bit

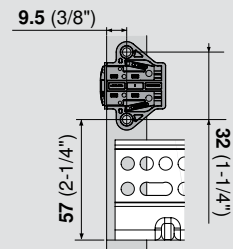

NOTE: Blum distance bumpers provide a travel of **3** (1/8")

Part no.

Screw-on bumper

993.1220

Installation screw

606N or 606P

SERVO-DRIVE locking device with integrated bumper



- Captive right device and self-aligning left device
- Self-adjusting drawer length tolerance
- Minimum inside drawer width **170** (6-11/16")
- Height adjustment **+3** (1/8")
- Side adjustment **±1.5** (1/16")
- Depth adjustment **+2.5** (3/32"), preset at **0**
- Minimum sub-front thickness **13** (1/2")
- Designed for **13** (1/2") drawer bottom recess
- Integrated **3** (1/8") distance bumper for inset or overlay SERVO-DRIVE applications

Part no.

SERVO-DRIVE locking device, left

T51.1901.PS L

SERVO-DRIVE locking device, right

T51.1901.PS R

Installation screw

606N or 606P

Installation

pg 64

Wiring options

Two base cabinets connected

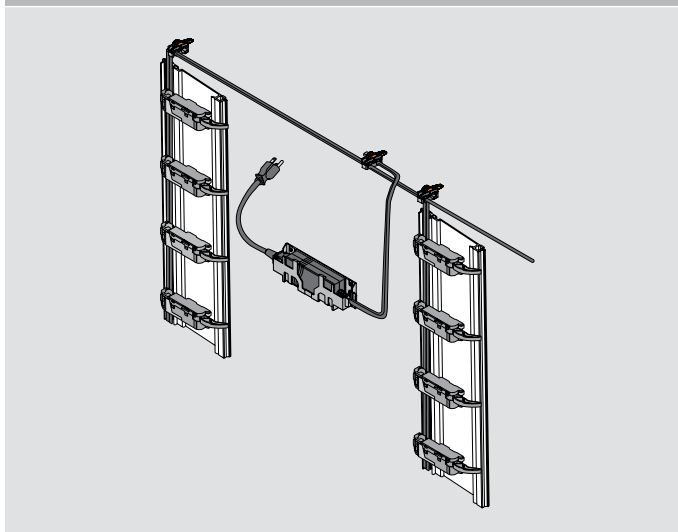

Individual drawer with top bracket

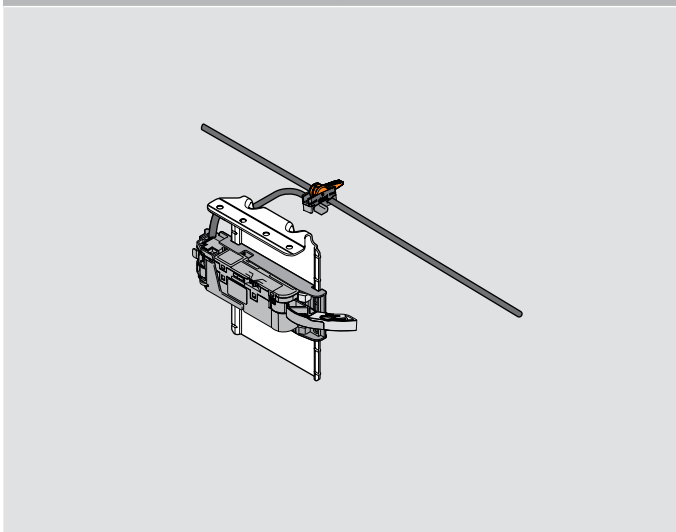

Cabinet with different applications

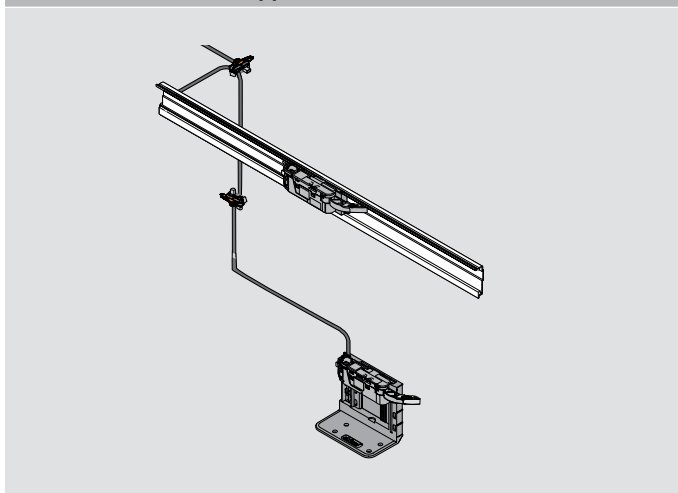

Bottom drawer with bottom bracket

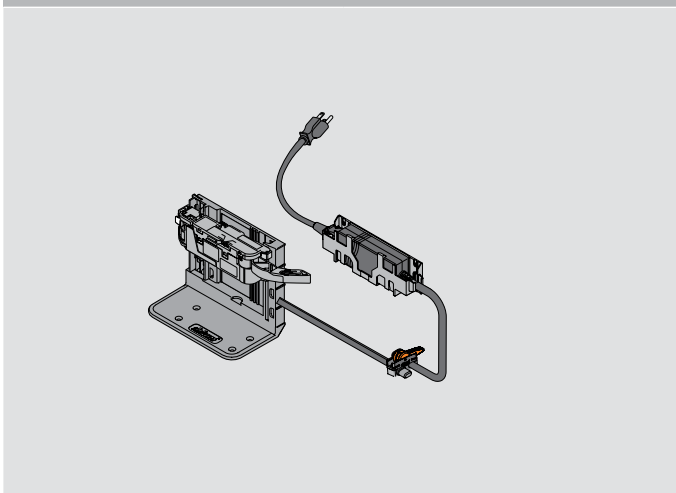

Two drawers connected with synchronization cable

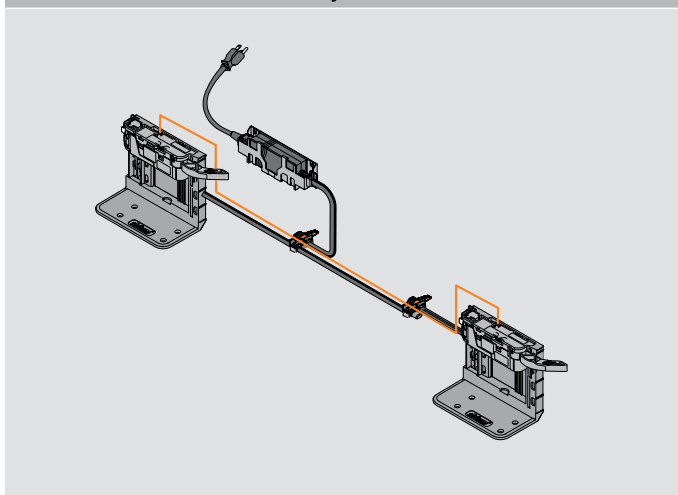

- Required when two drive units should open simultaneously
- Can be used in a variety of applications
- Connects directly to the back of the drive unit
- Available in two different lengths
- Cable color: cream

NOTE: Synchronization cable marked in orange

Assembly/removal

Installing cable onto vertical profile

- 1 Insert cable for power into the left channel of profile
- 2 Insert cable for communication into the right channel of profile

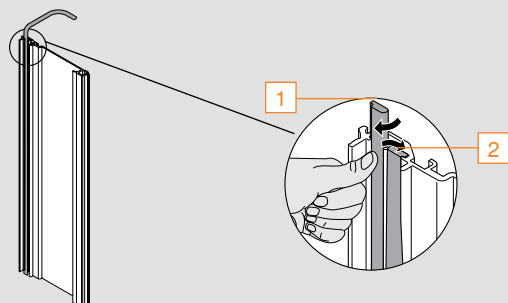

Installing cable onto bottom bracket

Insert cable from the rear of the bottom bracket

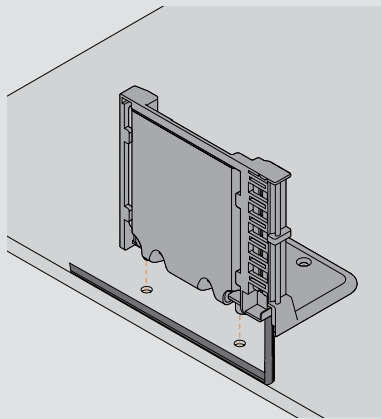

Installing cable onto horizontal profile

- 1 Insert cable for power into the bottom profile
- 2 Wrap cable behind profile

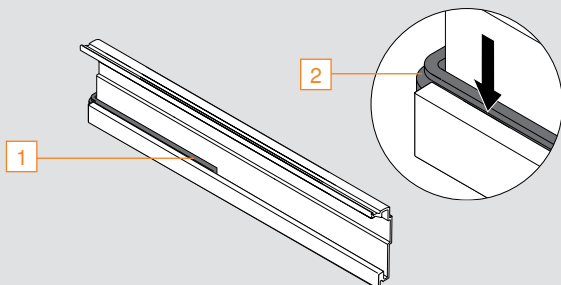

Installing cable onto horizontal adapter

Insert cable for power into the left channel of adapter

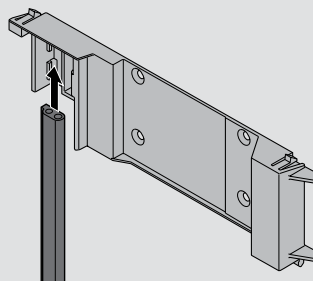

Installing cable connector

- 1 Insert cable for distribution into open slot
- 2 Insert cable for power into open slot
- 3 Rotate orange lever to lock into place
- 4 Slide cable end protector over exposed cable

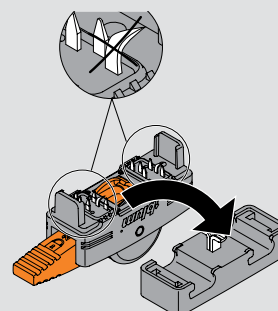
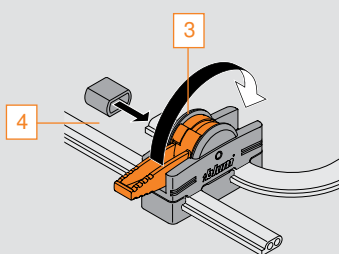
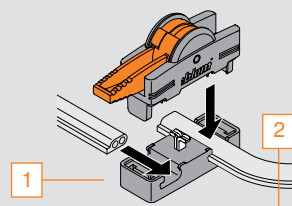

NOTE: Ensure piercing pins are not damaged

Installation of power supply

Minimum space requirements

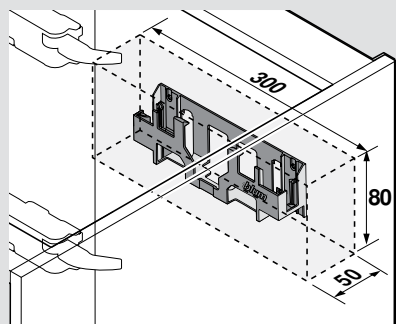

- 1 Insert power cord into power supply
- 2 Insert power supply into wall mount bracket

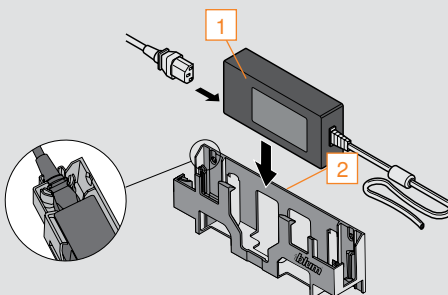

- 3 Attach wall mount bracket with four 606N or 606P screws

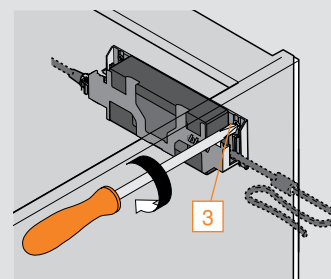

NOTE: Power supply can be mounted horizontally or vertically onto back panel

Drive unit installation

- 1 Open release lever and insert right hand side of drive unit

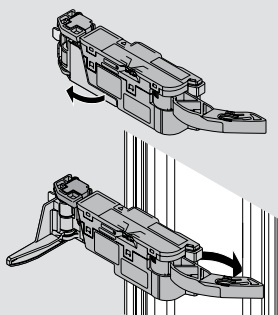

- 2 Open clip and align onto the profile slot and secure clip

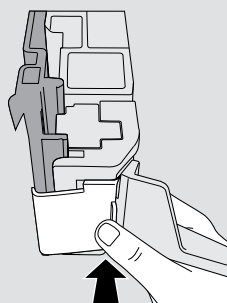

- 3 Close release lever

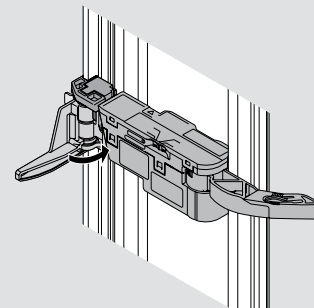

Drive unit removal

- 1 Open release lever

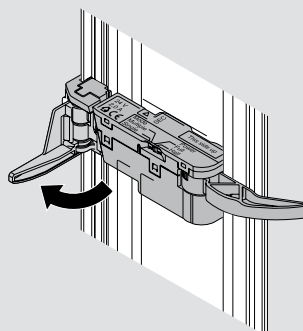

- 2 Lift up clip

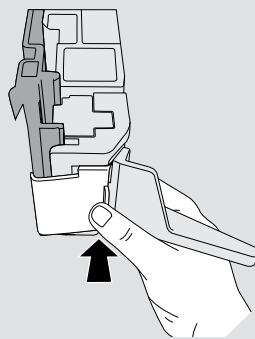

- 3 Pull outward and lift off profile

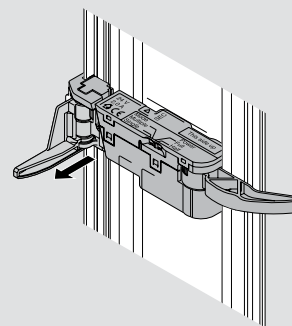

Assembly/removal

Lever arm extension

The drive unit comes with the lever arm extension pre-attached. The lever arm extension must be removed for cabinet widths of **305** (12") or less.

- 1 Press release button
- 2 Pull

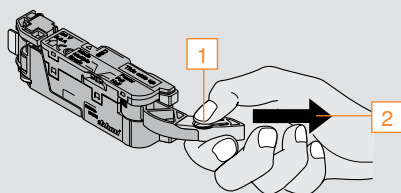

Drive unit adjustment

- 1 Operating mode display (LED)
- 2 Selector switch mode
Multiple: when set to "multiple" drive units move simultaneously
Single: only one drive unit moves (standard setting)
- 3 Selector switch power
Half: use for very small and/or light drawers
Full: standard settings for most applications

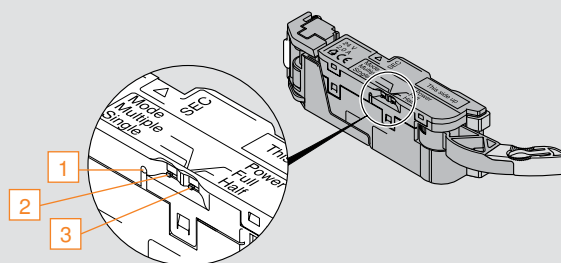

Installing synchronization cable

- 1 Insert synchronization cable into back of drive unit

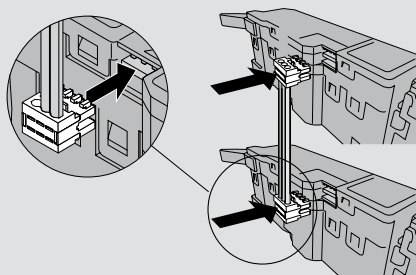

- 2 Reattach drive units

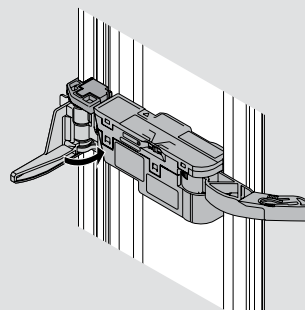

Installing the SERVO-DRIVE locking device

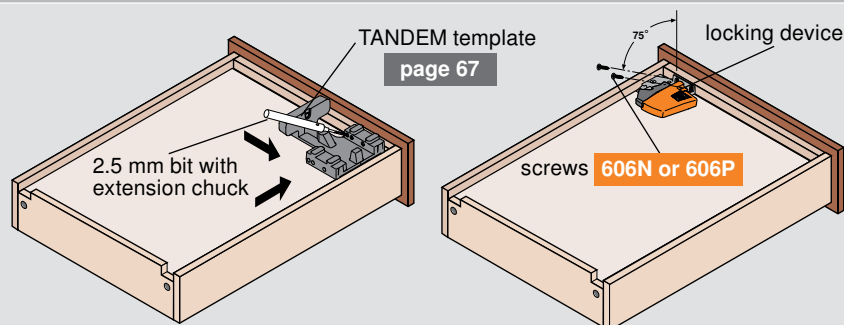

- 1 Position the 2.5 mm drill bit into the extension chuck so that it will bore **10** (13/32") deep
- 2 Place template into the front corner of the drawer
- 3 Bore two holes and repeat on other side
- 4 Attach locking devices with #6 x 5/8" deep thread wood screws (606N or 606P)

The mounting screws must go in at a precise angle and the locking device must fit flush to the drawer bottom to ensure proper function of the complete drawer system

NOTE: Using the **T65.1600.01** TANDEM template is highly recommended

Removing vertical profile from top and bottom adapters

- 1 Use screwdriver to assist in removing right side of adapters
- 2 Remove profile from cabinet

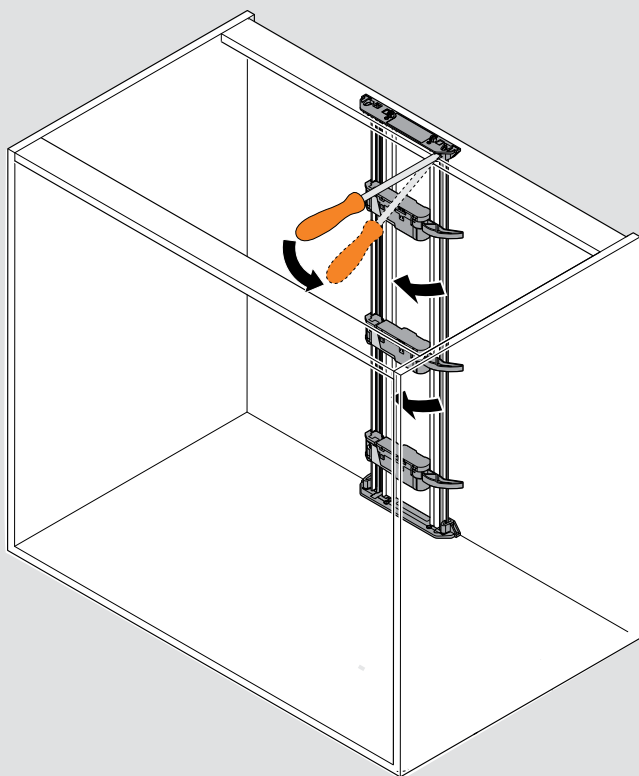
**Removing vertical profile from back and bottom adapters**

- 1 Use screwdriver to assist in removing right side of back adapter
- 2 Remove profile from cabinet

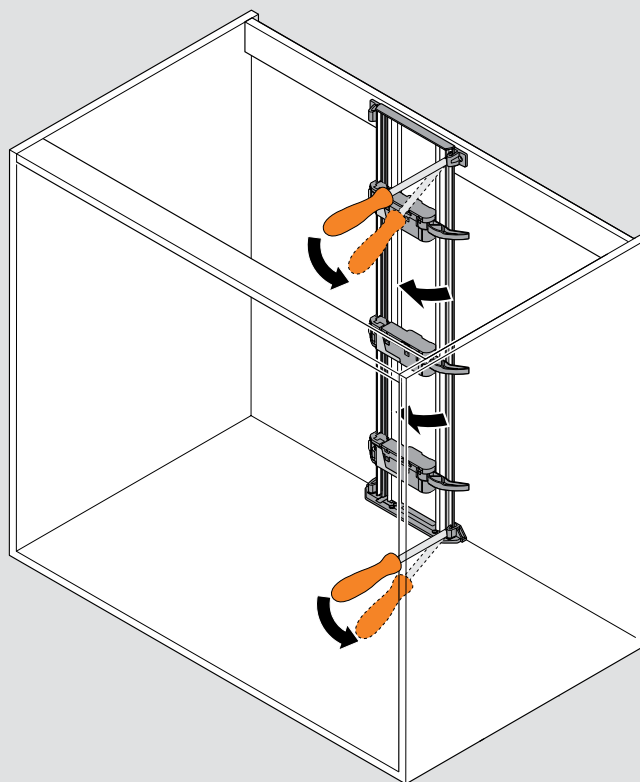
**Removing horizontal profile**

- 1 Use screwdriver to assist in removing profile from adapters
- 2 Remove profile from cabinet

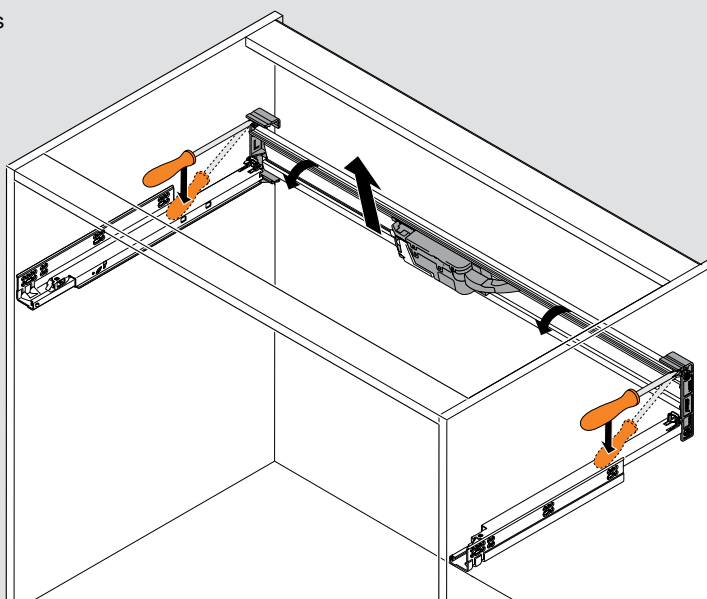

Assembly aids

SERVO-DRIVE boring template

Components



- Used to pre-bore for top and bottom adapters
- Can also be used to pre-bore for bottom bracket
- For use with TANDEM and TANDEMBOX

Includes:

- Template
- Instructions

Part no.

SERVO-DRIVE boring template

ZML.1150.US

Ø10 mm drill bit

DB-10mm

Using the SERVO-DRIVE boring template

1 Adjust view window to nominal length

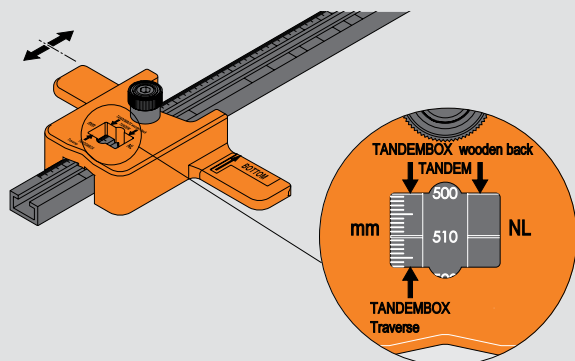

2 Mark center line of cabinet

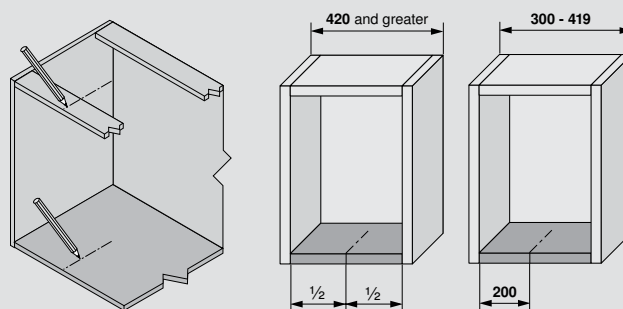

3 Align positioning arrow with center line

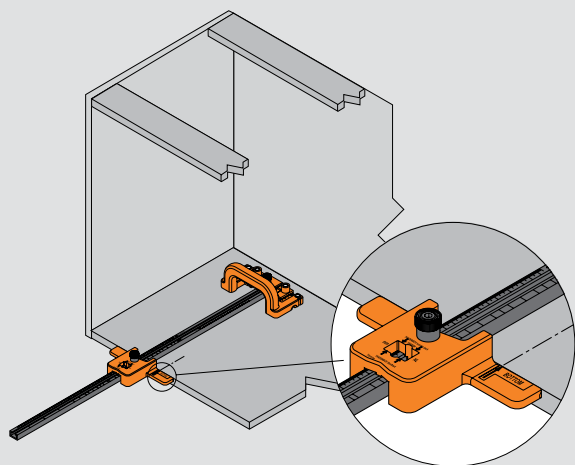

4 Bore two Ø10 mm holes for dowels, repeat for top adapter

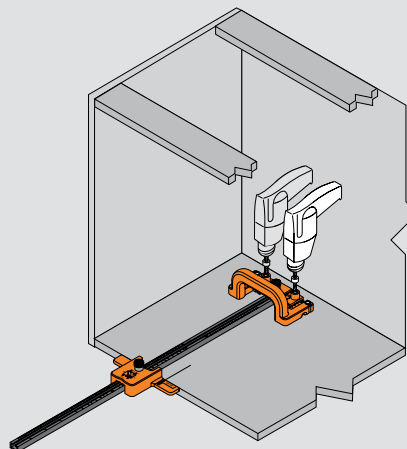

TANDEM template

Components

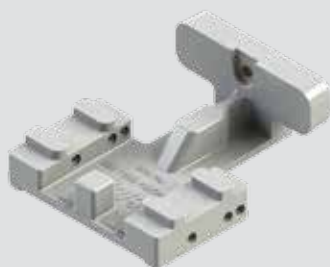

- Essential tool for drawers using TANDEM runners
- To bore the Ø6 mm holes for rear hooks
- Pre-bore Ø2.5 mm hole for TANDEM locking devices at the required angle

Part no.

TANDEM template	T65.1600.01
Accessories (order separately)	
Ø2.5 mm drill bit	DB-2.5mm
Ø6 mm drill bit	DB-6mm
Tool set	T65.9000

Rear notching

Dimensions

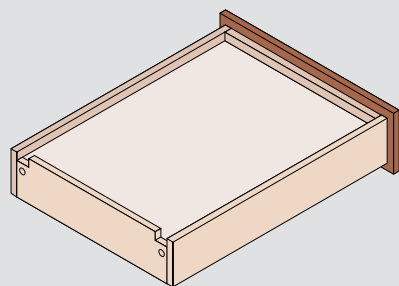

Drawers must be notched in the back to accommodate TANDEM runners

Rear view

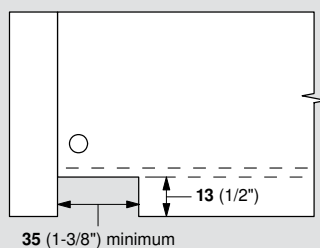

The notches must be flush with the drawer sides and bottom

Option – no notching

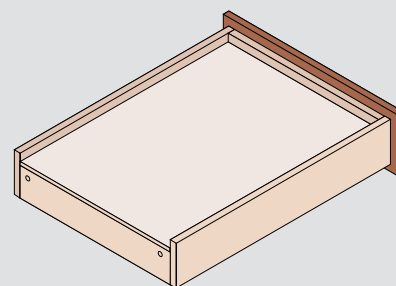

Make the back panel shorter and extend the drawer bottom to the back of the drawer

Rear boring

Dimensions

Rear view

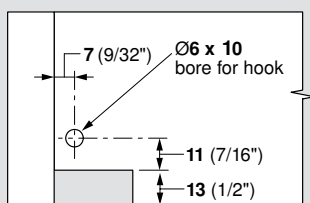

Drawers require 6 mm holes bored on each side of the back panel to accept the hooks on the back of TANDEM runners

Boring

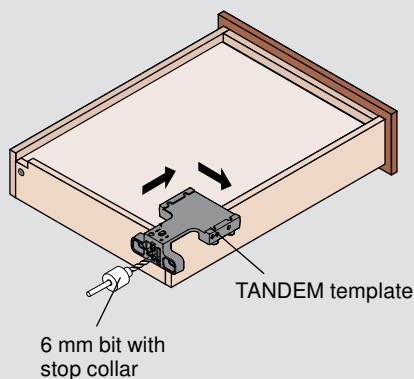

- 1 Place template over the drawer side
- 2 Position template so that the center rib rests against the inside face of the drawer side
- 3 Set stop collar on 6 mm bit so that it will bore 10 (13/32") deep
- 4 Hold template firmly and bore hole
- 5 Repeat on other side

NOTE: Using the **T65.1600.01** TANDEM template is highly recommended

POZI DRIVER and bits



A POZI screwdriver (different from Phillips) is the most crucial tool you can use to assure that full torque is applied to all Blum POZI mounting screws. POZI screws can be identified by the distinctive "tick" marks located in the center of the screw head recess.

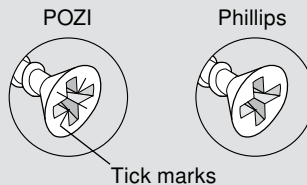

Part no.

#2 POZI DRIVER	POZI DRIVER
1/4" Magnetic bit holder	BIT HOLDER
#2 x 1" POZI bit insert	POZI BIT #2x1
#2 x 2" POZI bit insert	POZI BIT #2x2

Twist drill bits



Part no.

Ø2.5 mm, right handed	DB-2.5mm
Ø5 mm, right handed	DB-5mm
Ø6 mm, right handed	DB-6mm
Ø10 mm, right handed	DB-10mm

Deep thread system screw

Pilot bore Ø5 (3/16") hole

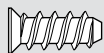

Part no.

#7 x 13 mm, #2 POZI	661.1300.HG
#7 x 11.5 mm, #2 POZI	661.1150.HG

Deep thread wood screw

Pilot bore Ø2.5 (3/32") hole



Part no.

#6 x 5/8", #2 Phillips	606N
#6 x 5/8", #2 POZI	606P

TANDEMBOX front stabilization bracket

For use on tall fronted drawers using SERVO-DRIVE

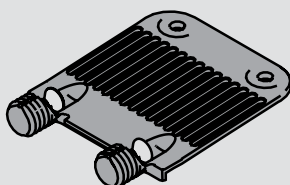

Part no.

Front stabilization bracket	Z96.10E1
-----------------------------	-----------------

Front stabilization bracket application

Space requirements

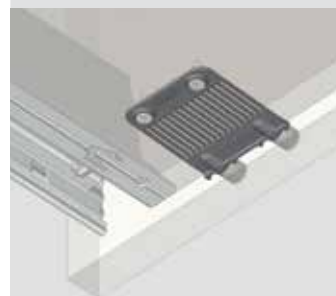
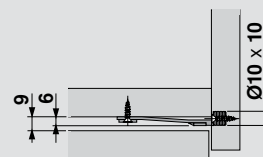

Front boring dimensions

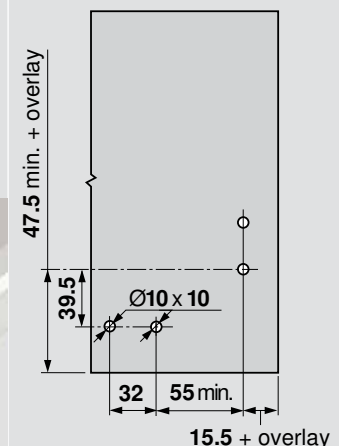

Part number index



Part No.	Page No.
606N	32, 36, 39, 44, 52, 59, 60, 68
606P	32, 36, 39, 44, 52, 59, 60, 68
661.1150.HG	68
661.1300.HG	24, 28, 44, 48, 68
993.0531	9, 17, 24, 32, 41, 45, 48, 52, 60
993.1220	9, 17, 24, 32, 41, 45, 48, 52, 60
BIT HOLDER	68
DB-10mm	66, 68
DB-2.5mm	67, 68
DB-5mm	68
DB-6mm	67, 68
POZI BIT #2x1	68
POZI BIT #2x2	68
POZI DRIVER	68
T59.A5P0S	39
T51.1901.PS L	13, 21, 28, 36, 60
T51.1901.PS R	13, 21, 28, 36, 60
T65.1600.01	67
T65.9000	67
Z10A3000.02	9, 12, 17, 21, 24, 28, 32, 36, 41, 45, 48, 52
Z10D01E0.01	8, 12, 40
Z10D01EA.01	8, 40
Z10D5210.US	44
Z10D5800.US	16, 20
Z10D6252	24, 28, 48
Z10D7201.01	32, 36, 52
Z10K0009	59
Z10K008S	59
Z10K120S	59
Z10K800AE	59
Z10M200U	59
Z10NA20UGUS	33, 37, 53, 56
Z10NE020G	58
Z10NE02UG10	9, 13, 17, 21, 25, 29, 33, 37, 41, 45, 49, 53, 57
Z10NG120	59
Z10T1143B	16, 20, 44
Z10T1170A	8, 12, 40
Z10T720AB	8, 12, 40
Z10V1000.01	59
Z10V100E.01	59
Z96.10E1	68
ZML.1150.US	66



Blum, Inc. Headquarters, Stanley NC

Why choose Blum



Blum, Inc. is a leading manufacturer of functional hardware for the kitchen cabinet and commercial casework industries specializing in lift systems, concealed hinges and drawer runner systems. Virtually all of the hardware needed to assemble and make cabinets functional is available within the wide range of quality Blum products. Blum supports the U.S. market with a network of more than 150 dependable distributors, 40+ knowledgeable Blum sales representatives and an experienced customer service department.

Commitment to manufacturing in the U.S.

Blum manufactures many of its products in our 450,000 sq ft manufacturing, logistics and warehouse facility located in Stanley, North Carolina. Manufacturing closer to the customer allows Blum to react quickly to changing customer needs including unexpected surges in demand. Customer pickups and deliveries can be timed to better match their production schedules. Blum is committed to manufacturing in the U.S. for the U.S. market.

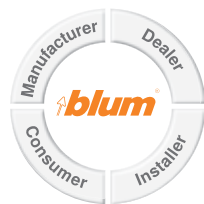

Product development at Blum considers all of the various customers who will come in contact with our products. With this “Global Customer Benefits” philosophy we strive to create advantages for all users.



Blum, Inc. is ISO 9001 certified which means that you are assured of consistent quality in every Blum product. What's more they exceed the requirements of ANSI/BHMA standards for cycle life, static load and self-closing performance.



Please visit blum.com for information on other Blum products.
LIT-SDR1000.02.13 © 2013 Blum, Inc. Printed in the USA

Blum, Inc.
7733 Old Plank Rd.
Stanley, NC 28164
800-438-6788
blum.com

